

LONDON BOROUGH OF HILLINGDON
THE HILLINGDON (WAITING & LOADING RESTRICTIONS)
ORDER 2023 (AMENDMENT) ORDER 2025
THE HILLINGDON (FREE PARKING PLACES)

(DISABLED PERSONS) TRAFFIC ORDER 2024 (AMENDMENT) ORDER 2025

Hillingdon Council gives notice that it proposes to make these Orders to:

1. Install 'at any time' waiting restrictions in sections of roads as set out in the Schedule to this notice below.

2. Install blue badge disabled parking bays at the following locations:

- i) Outside Nos. 32 / 34 Bromley Crescent, Ruislip
- ii) Outside Nos. 9 / 18 Lyttleton Court, Dunedin Way, Hayes

3. Remove the redundant blue badge disabled parking bays at the following locations:

- i) Outside No. 8 Standale Grove, Ruislip
- ii) Outside No. 10 Standale Grove, Ruislip
- iii) Outside No. 12 Standale Grove, Ruislip
- iv) Outside No. 8, Towers Court, Pole Hill Road, Hillingdon
- v) Outside Nos. 469 – 523 Victoria Road, Ruislip

4. Convert existing waiting restrictions to 'at any time' waiting restrictions on the following sections of road:

- i) UXBRIDGE ROAD, HILLINGDON – Southwest side, from a point in line with the common boundary of Nos. 6 and 7 Hillingdon Parade, northwestwards to a point 7 metres northwest of the northwestern kerbline of Lees Road.
- ii) LEES ROAD, HILLINGDON – Both sides, from a point in line with the southwestern kerbline of Uxbridge Road, southwestwards to a point in line with the northeastern boundary of No. 2 Lees Road.

Copies of the notice of proposals, proposed Orders together with full details, plans and the Council's statement of reasons for the proposals can be sent upon request or viewed online at <https://www.hillingdon.gov.uk/improvement-schemes> until 12th March 2025. Further information can be obtained by email parkingmanagementschemes@hillingdon.gov.uk. If you wish to comment on, or object to the proposals please write or email by 12th March 2025, stating grounds for objection and your home address to Transport & Projects, 3N/04 Civic Centre, Uxbridge, Middlesex UB8 1UW quoting reference 3N/04/19/02/25.

Dated this the 19th day of February 2025.

KARRIE WHELAN,
Corporate Director Place

SCHEDULE - PROPOSED 'AT ANY TIME' WAITING RESTRICTIONS

PERRY CLOSE, HILLINGDON – On the corners of the junction opposite Nos. 7 to 9 Perry Close.

SOUTH ROAD, WEST DRAYTON – At the junction with South Close and all sides of the island.

SOUTH CLOSE, WEST DRAYTON – At the junction with South Road and all sides of the island.

ABINGDON CLOSE, HILLINGDON – Near the turning area outside No. 9 Abingdon Close.

CHENEY STREET, EASTCOTE – Outside Nos. 8 to 12 Cheney Street.

STATEMENT OF REASONS

The proposed installation of waiting restrictions in various roads is intended to remove obstructive parking to assist free flow of traffic and promote road safety. This will particularly assist emergency vehicles, refuse and recycling trucks, delivery vans and other large vehicles. All proposals have been agreed by the Cabinet Member for Planning, Housing & Growth.

The proposed disabled parking bays are intended to benefit disabled people by providing parking bays for the sole use of "blue badge" holders. Redundant bays will be removed to provide more parking for residents and their visitors.

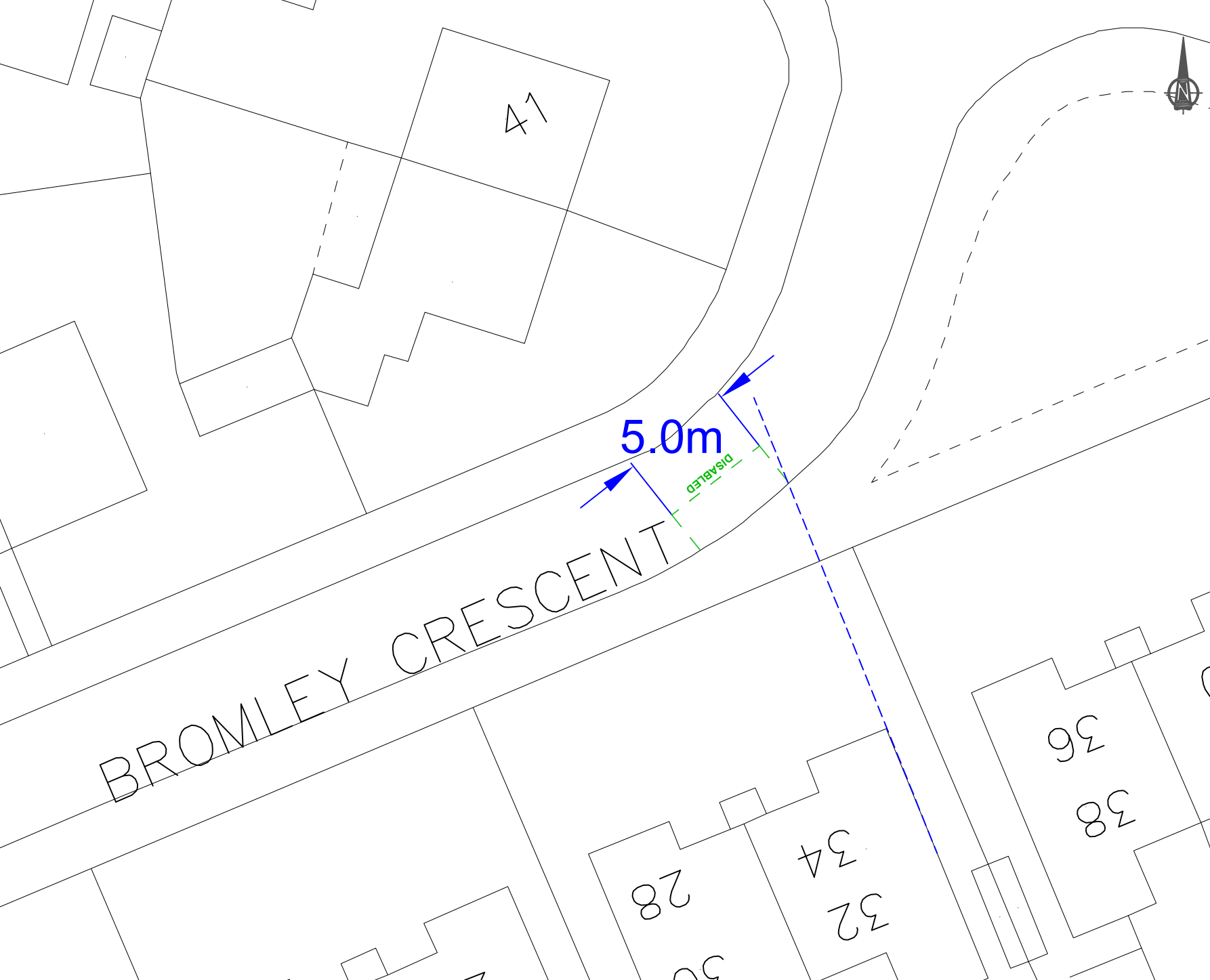

DISABLED

Proposed disabled parking bay

This map is based upon Ordnance Survey material with the permission of Ordnance Survey on behalf of the Controller of Her Majesty's Stationery Office © Crown copyright. Unauthorised reproduction infringes Crown copyright and may lead to prosecution or civil proceedings.
London Borough of Hillingdon 100019283 2025



HILLINGDON
LONDON

Project
Proposed Disabled Bay

Source RSP/CAD drawings/Bedford Rd-Clyfford Road ped refuge

Description
Bromley Crescent, Ruislip

Scale	Drawn	Checked
N.T.S	CH 01/25	
Paper Size	Drawing No.	Rev.
A4		



Proposed disabled parking bay



Existing disabled parking bay

This map is based upon Ordnance Survey material with the permission of Ordnance Survey on behalf of the Controller of Her Majesty's Stationery Office © Crown copyright. Unauthorised reproduction infringes Crown copyright and may lead to prosecution or civil proceedings.
London Borough of Hillingdon 100019283 2025



HILLINGDON
LONDON

Project

Proposed Disabled Bay

Source

RSP/CAD drawings/willow tree Lane-Yeading Fork

Description

Dunedin Way, Hayes

Scale

N.T.S

Drawn

CH . 01/2025

Checked

Paper Size

A4

Drawing No.

Rev.

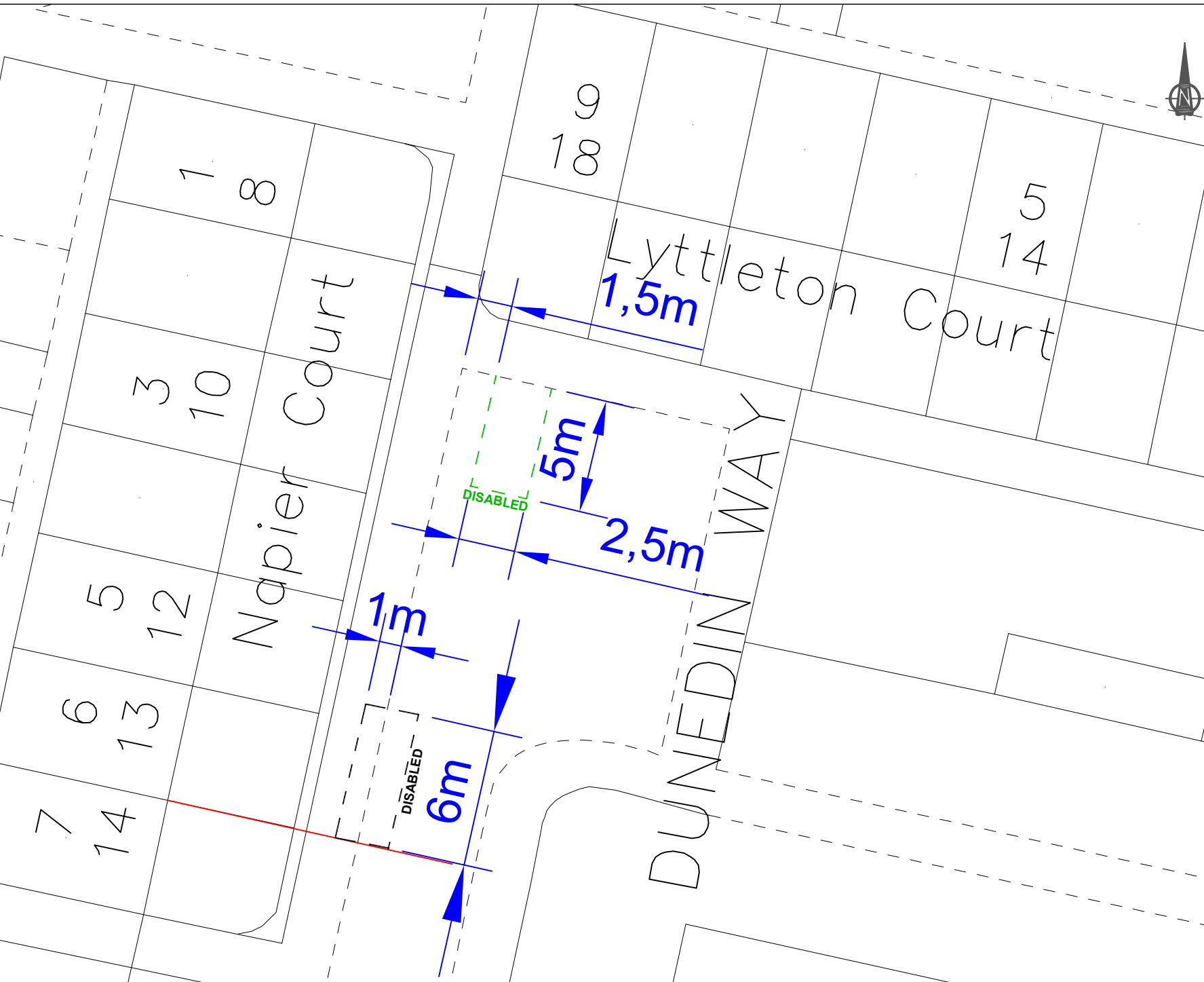

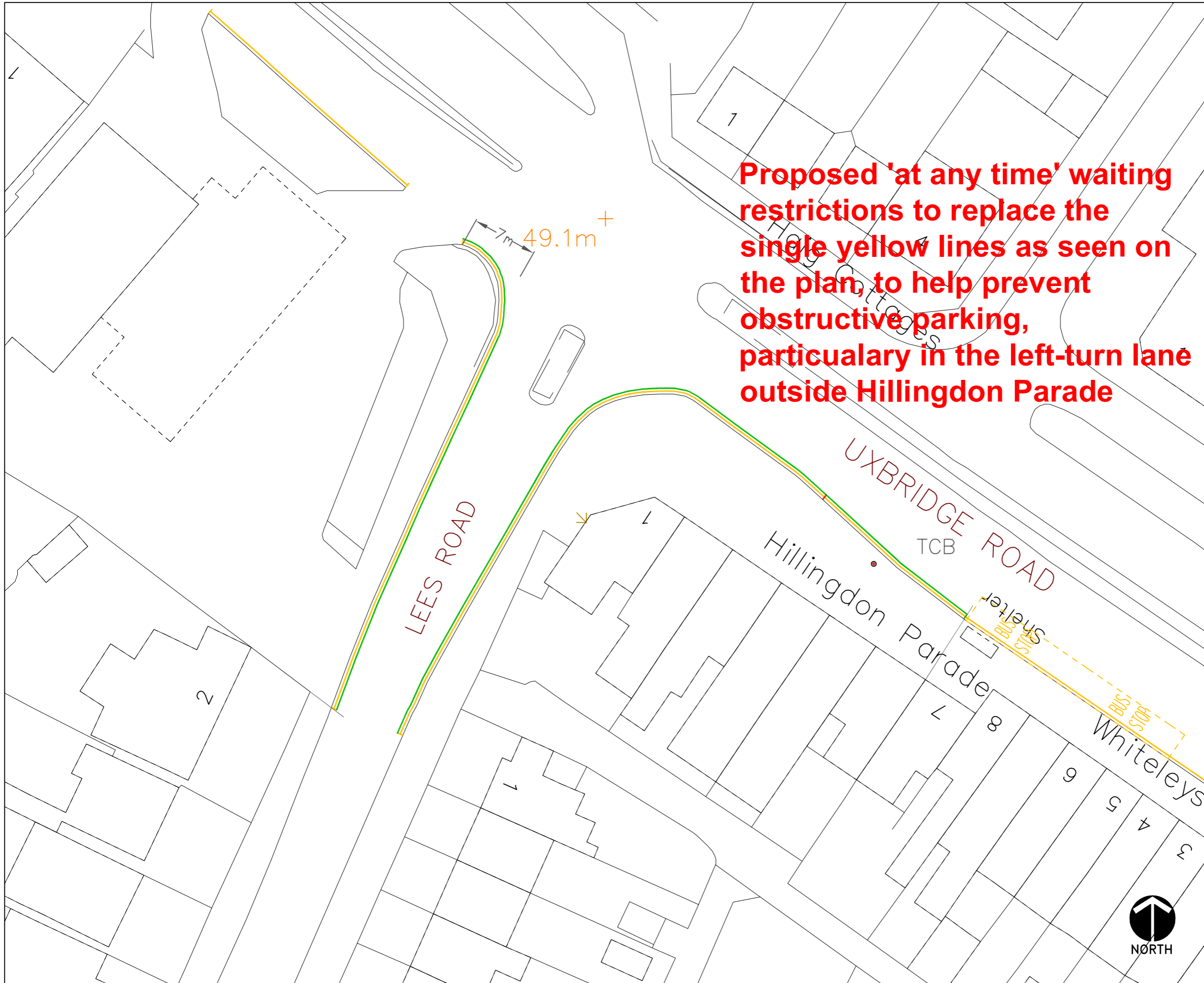

Proposed 'at any time' waiting restrictions to replace the single yellow lines as seen on the plan, to help prevent obstructive parking, particularly in the left-turn lane outside Hillingdon Parade

KEY	
	EXISTING YELLOW LINE
	NEW SINGLE YELLOW LINE & TERMINAL
	NEW DOUBLE YELLOW LINE & TERMINAL
	PAY AND DISPLAY AND PERMIT HOLDERS
	PERMIT HOLDER ONLY BAY
	PAY & DISPLAY BAY
	BUSINESS, PERMIT HOLDER ONLY BAY
	LOADING BAY
	DISABLED BAY
	MOTORCYCLE BAY
	CROSSOVER
	EXTENT OF PRIVATE ROADS

This map is based upon Ordnance Survey material with the permission of Ordnance Survey on behalf of the Controller of Her Majesty's Stationery Office © Crown copyright.
 Unauthorised reproduction infringes Crown copyright and may lead to prosecution or civil proceedings.
 London Borough of Hillingdon 100019283 © 2019

HILLINGDON
 LONDON

Residents Services, 3N/04, Civic Centre, High Street, UB8 1UW,
 London Borough of Hillingdon
 Tel 01895 250 631

Project
Lees Road and Uxbridge Road, Uxbridge

Description
 Proposed 'at any time' waiting restrictions

Scale	Designed	Drawn	Date July 2024
-------	----------	-------	-------------------

Project No.	Drawing No.	Rev.
-------------	-------------	------



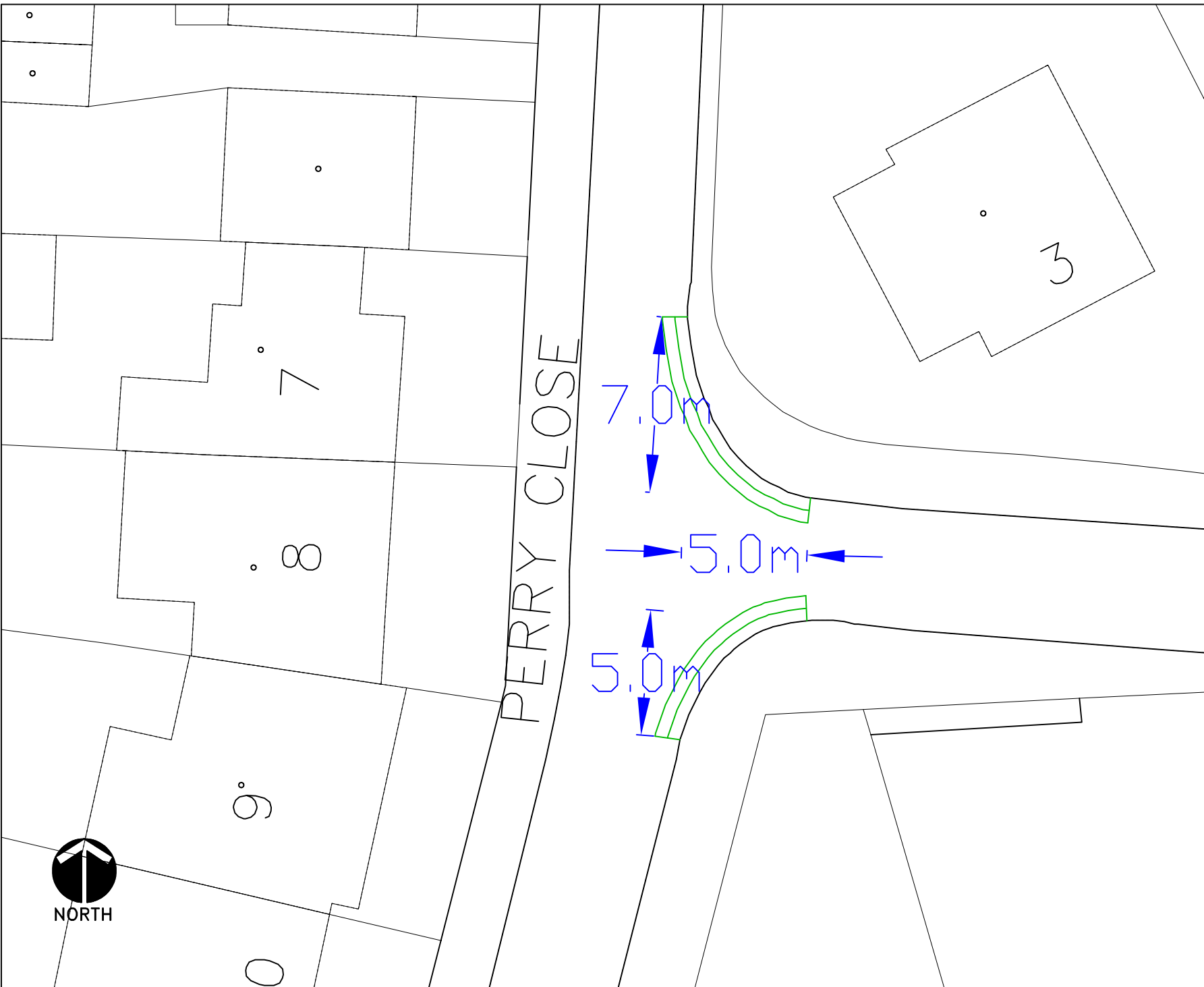

KEY

 Install double yellow lines

This map is based upon Ordnance Survey material with the permission of Ordnance Survey on behalf of the Controller of Her Majesty's Stationery Office. © Crown copyright. Unauthorised reproduction infringes Crown copyright and may lead to prosecution or civil proceedings.
 London Borough of Hillingdon 100019283 ©2024



HILLINGDON
LONDON

Project
 Road Safety Programme

RSP/CAD/Judge Heath Lane
Description
 Perry Close, Hillingdon

Scale	Drawn (Initials/Date)	Checked (Initials/Date)
NTS	CH 12/24	
Project No.	Drawing No.	Rev.
A4		



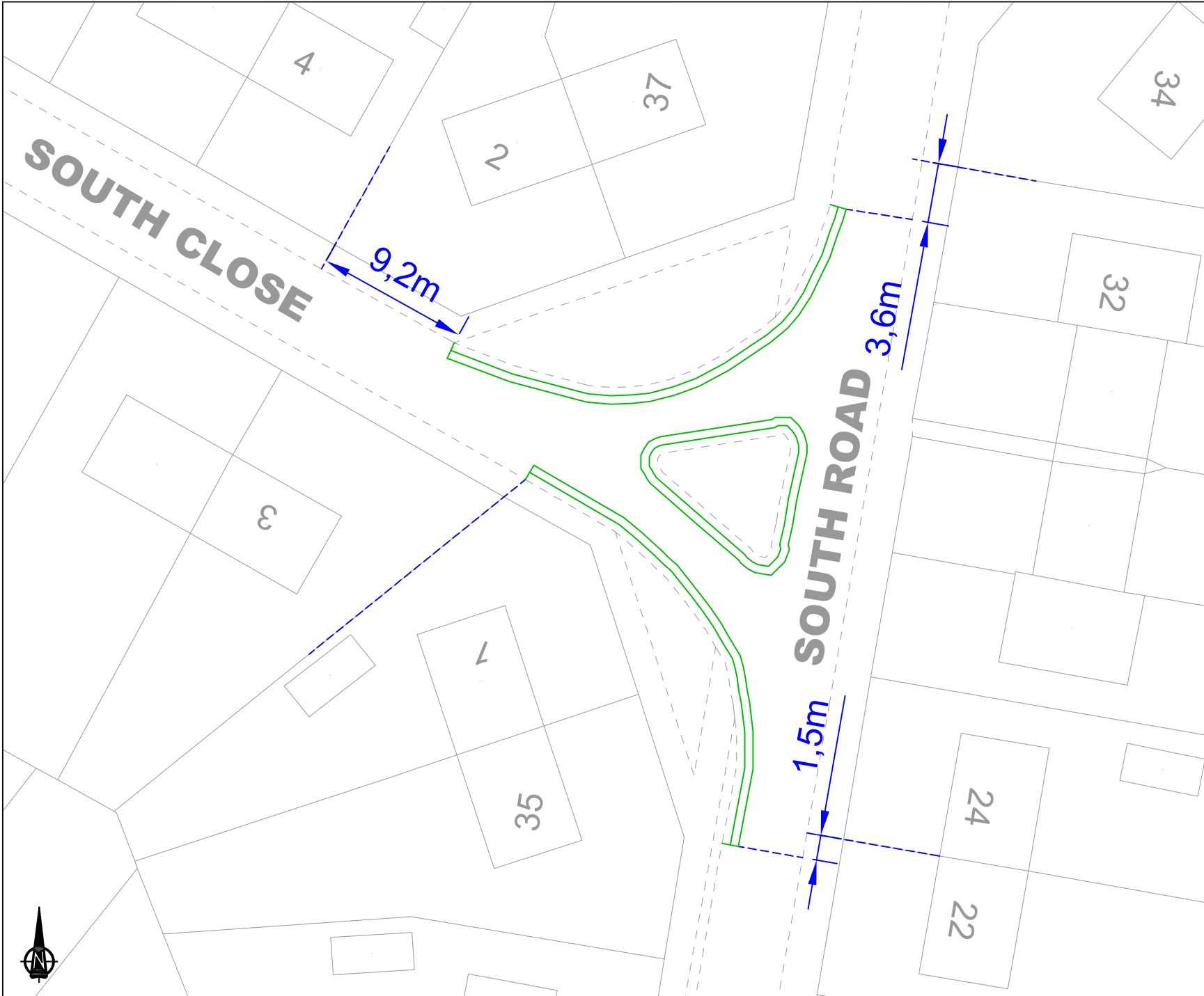

 DYL
 PROPOSED DOUBLE YELLOW
 LINE & TERMINAL

This map is based upon Ordnance Survey
 material with the permission of Ordnance Survey
 on behalf of the Controller of Her
 Majesty's Stationery Office © Crown copyright.
 Unauthorised reproduction infringes Crown
 copyright and may lead to prosecution or
 civil proceedings.
 London Borough of Hillingdon 100019283 2024



HILLINGDON
 LONDON

Project
Road Safety Programme

Description
 South Road / South Close, West Drayton

Scale N.T.S	Drawn CH. 12/24	Checked
Paper Size A4	Drawing No.	Rev.

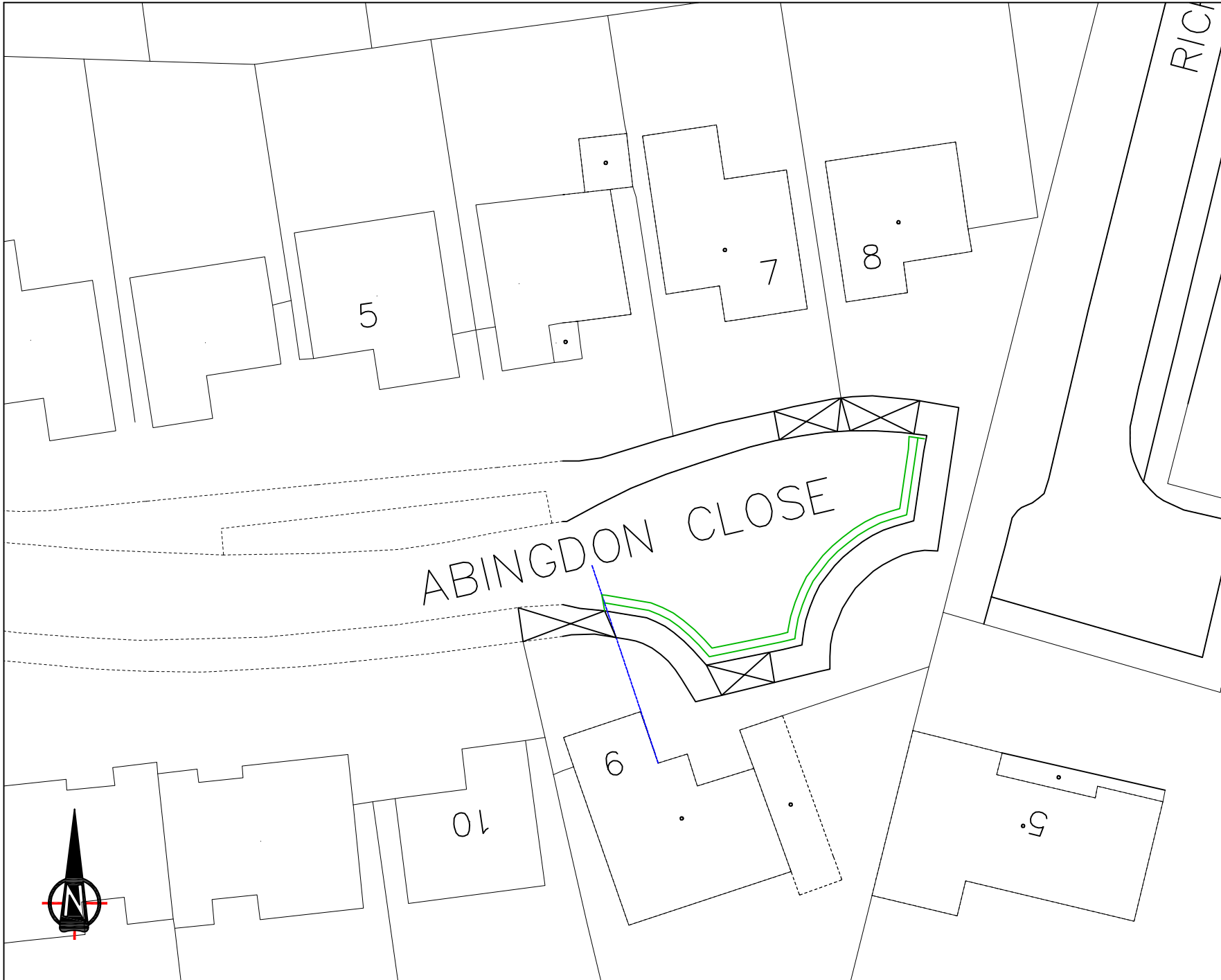

Notes:

 Proposed double yellow lines

 Dropped kerb

This map is based upon Ordnance Survey material with the permission of Ordnance Survey on behalf of the Controller of Her Majesty's Stationery Office © Crown copyright. Unauthorised reproduction infringes Crown copyright and may lead to prosecution or civil proceedings.
London Borough of Hillingdon 100019283 2024



HILLINGDON
LONDON



Project
Road Safety Programme

Description
Abingdon Close, Hillingdon

Scale	Drawn	(Initials/Date)	Checked	(Initials/Date)
N.T.S	CH	10/24		

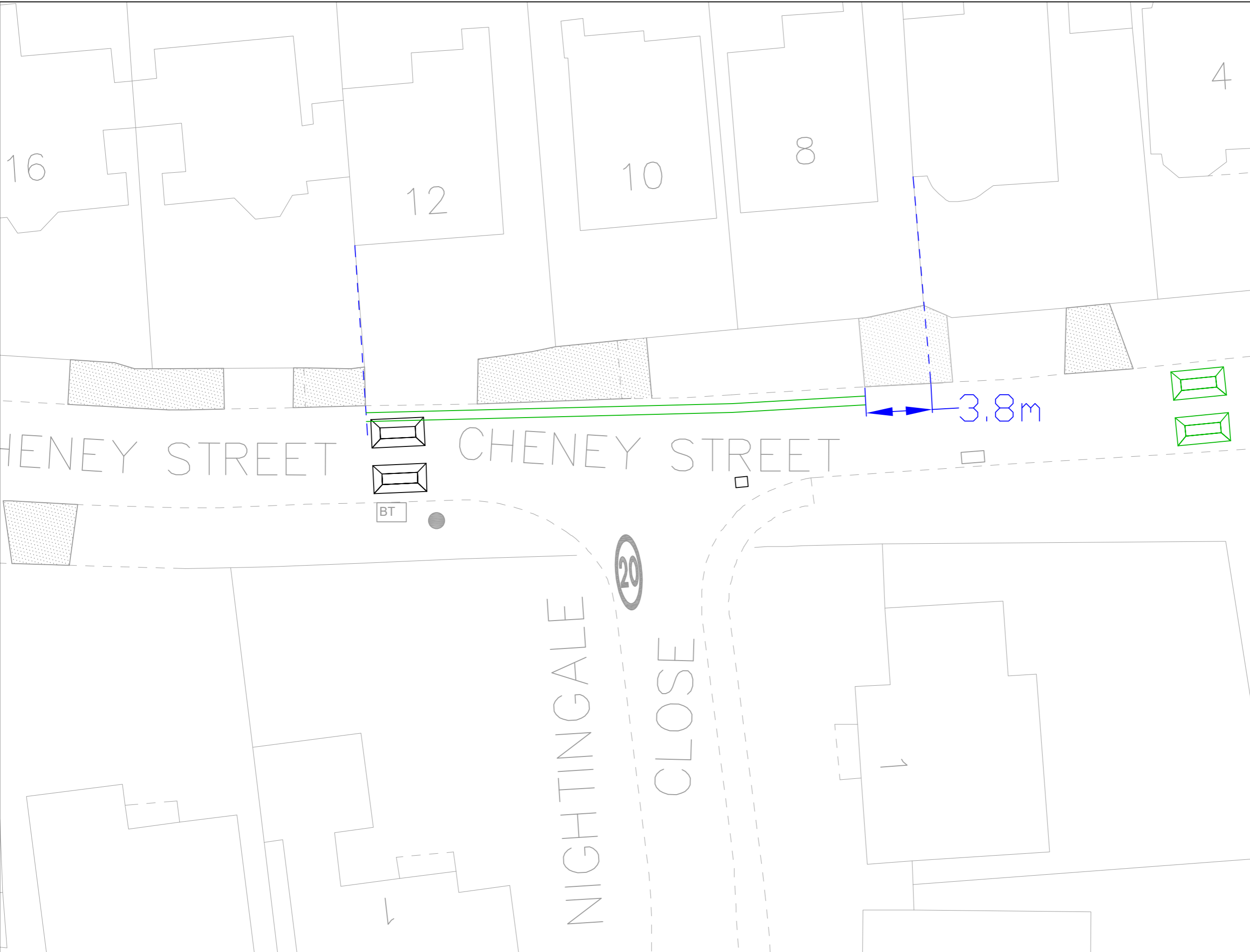
Project No.	Drawing No.	Rev.
A4		



-  Vehicle Crossover
-  Speed cushion
-  proposed double yellow lines

This map is based upon Ordnance Survey material with the permission of Ordnance Survey on behalf of the Controller of Her Majesty's Stationery Office. © Crown copyright. Unauthorised reproduction infringes Crown copyright and may lead to prosecution or civil proceedings.
London Borough of Hillingdon 100018283 5025



Project
Road Safety Programme

Description
CHENEY STREET

Scale	Design	Drawn	Date
			01/25
Project No.	Drawing No.	Rev.	
		A	

LONDON BOROUGH OF HILLINGDON
THE HILLINGDON (ON STREET PARKING PLACES) (YIEWSLEY PARKING MANAGEMENT SCHEME) Y ZONES ORDER 2024 (AMENDMENT) ORDER 2025
THE HILLINGDON (ON STREET PARKING PLACES) (HILLINGDON HILL PARKING MANAGEMENT SCHEME) ZONE HN1 ORDER 2023 (AMENDMENT) ORDER 2025
THE HILLINGDON (ON STREET PARKING PLACES) (NORTHWOOD HILLS PARKING MANAGEMENT SCHEME) NWH & JS(B) ZONES ORDER 2022 (AMENDMENT) ORDER 2025
THE HILLINGDON (ON STREET PARKING PLACES) (HAYES END & HILLINGDON HEATH PARKING MANAGEMENT SCHEMES) HE & VC ZONES ORDER 2023 (AMENDMENT) ORDER 2025
THE HILLINGDON (ON STREET PARKING PLACES) (HILLINGDON HOSPITAL PARKING MANAGEMENT SCHEME) HH ZONES ORDER 2022 (AMENDMENT) ORDER 2025
THE HILLINGDON (ON STREET PARKING PLACES) (WEST DRAYTON PARKING MANAGEMENT SCHEME) WD ZONES ORDER 2024 (AMENDMENT) ORDER 2025
THE HILLINGDON (ON STREET PARKING PLACES) (UXBRIDGE NORTH PARKING MANAGEMENT SCHEME) ZONES U1, U3, U7, U8, U9 & U10 ORDER 2023 (AMENDMENT) ORDER 2025

Hillingdon Council gives notice that it proposes to make these Orders to **remove the following sections of permit holder parking places to facilitate the installation of new vehicle crossings:**

- i) Remove a section of Zone Y1 parking place outside No. 48 Albert Road, Yiewsley and replace with 'Monday to Saturday 9am to 6pm' waiting restrictions.
- ii) Remove the entire of Zone HN1 parking place outside No. 72 Hillingdon Hill, Uxbridge and replace with 'Monday to Friday 9am to 5pm' waiting restrictions.
- iii) Remove a section of Zone NWH parking place outside No. 101 Potter Street, Northwood Hills and replace with 'Monday to Friday 1pm to 4pm' waiting restrictions.
- iv) Remove a section of Zone HE parking place outside No. 41 Hewens Road, Hayes and replace with 'Monday to Friday 8am to 10am and 2.30pm to 4.30pm' waiting restrictions.
- v) Remove a section of Zone HH parking place outside No. 36 Beechwood Avenue, Hillingdon and replace with 'Monday to Friday 9am to 5pm' waiting restrictions.
- vi) Remove the entire of Zone WD1 parking place outside No. 19 Cherry Orchard, West Drayton and replace with 'Monday to Friday 9am to 5pm' waiting restrictions.
- vii) Remove a section of Zone U1 parking place outside No. 24 Bawtree Road, Uxbridge and replace with 'Monday to Saturday 9am to 5pm' waiting restrictions.

Copies of the notice of proposals, proposed Orders together with full details, plans and the Council's statement of reasons for the proposal can be sent upon request or viewed online at <https://www.hillingdon.gov.uk/improvement-schemes> until 12th March 2025. Further information can be obtained by email parkingmanagementschemes@hillingdon.gov.uk. If you wish to comment on, or object to the proposals please write or email by 12th March 2025, stating grounds for objection and your home address to Transport & Projects, Place Directorate, Civic Centre, Uxbridge, Middlesex UB8 1UW quoting reference 3N/04/19/02/25.

Dated this the 19th day of February 2025.

KARRIE WHELAN,
Corporate Director Place

STATEMENT OF REASONS

The proposed removal of parts of existing permit holder parking places are intended to provide clear access to new off-street parking areas being created in line with the Highways policy for new vehicle crossings and approved by the Council's Highways Delivery Manager.

48 Albert Road, Yiewsley

Amendments to accommodate a new vehicle crossing

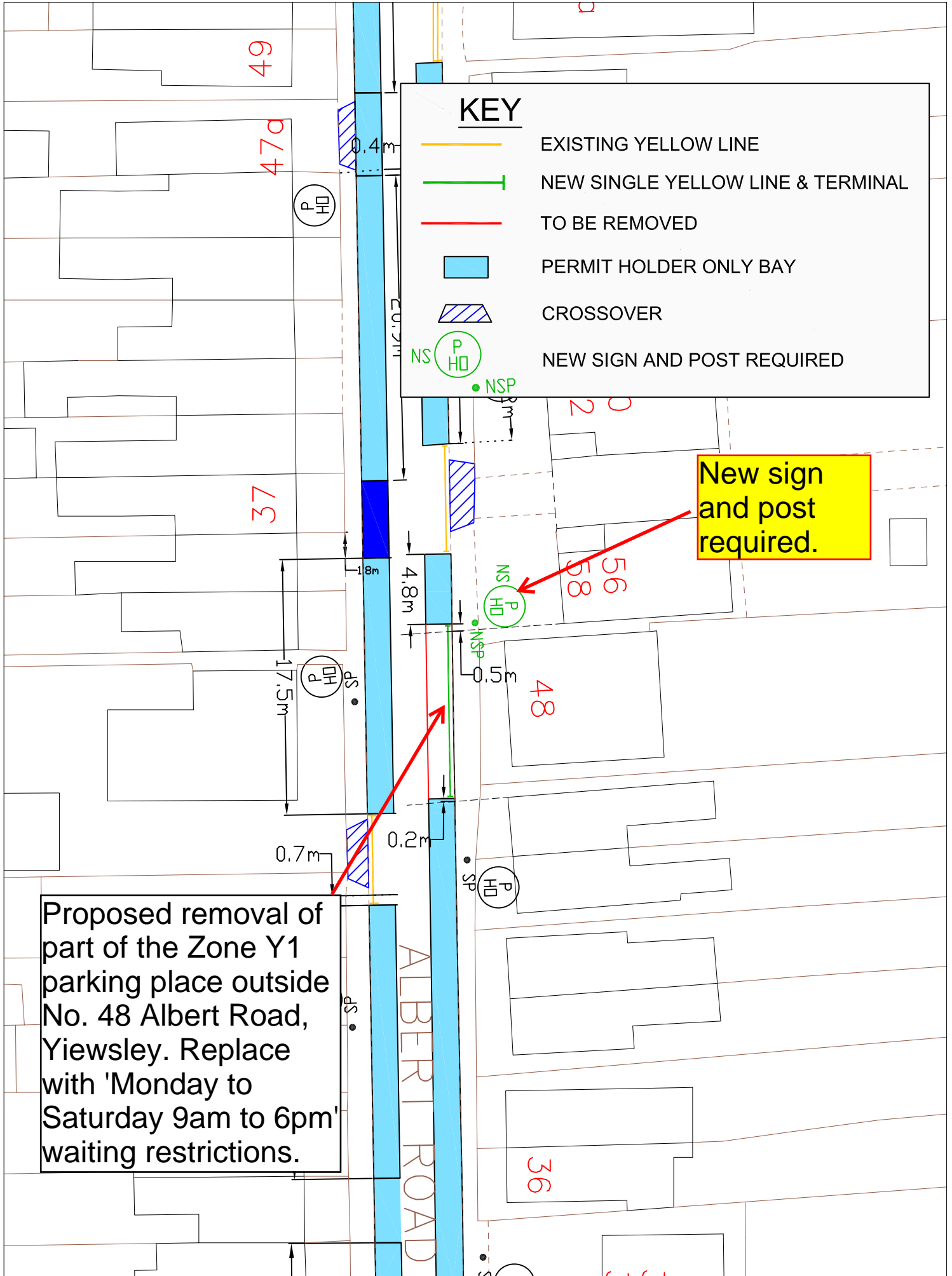

72 Hillingdon Hill, Uxbridge

Removal of parking place for a new vehicle crossing

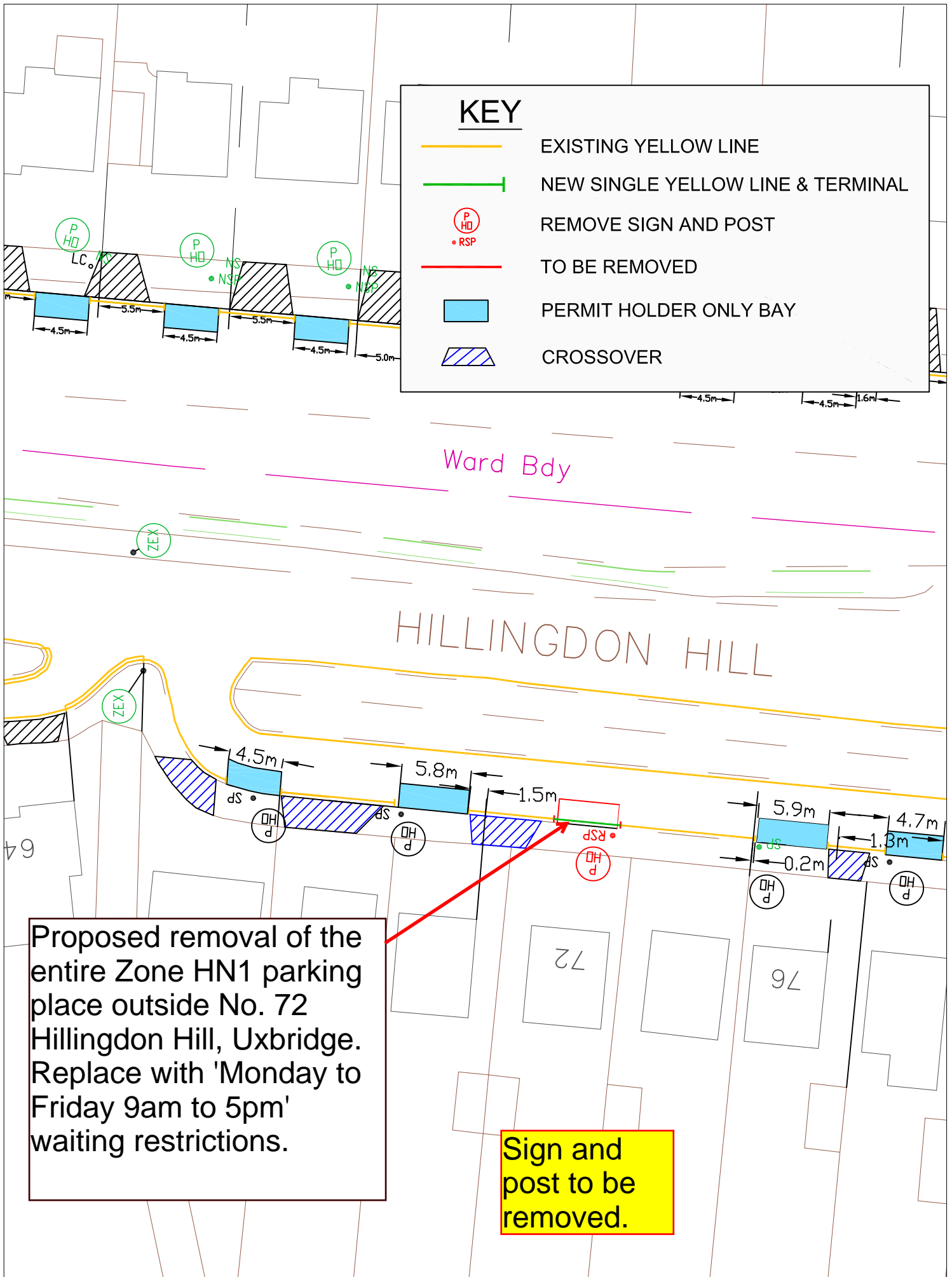

Proposed removal of part of the Zone NWH parking place outside No. 101 Potter Street, Northwood Hills

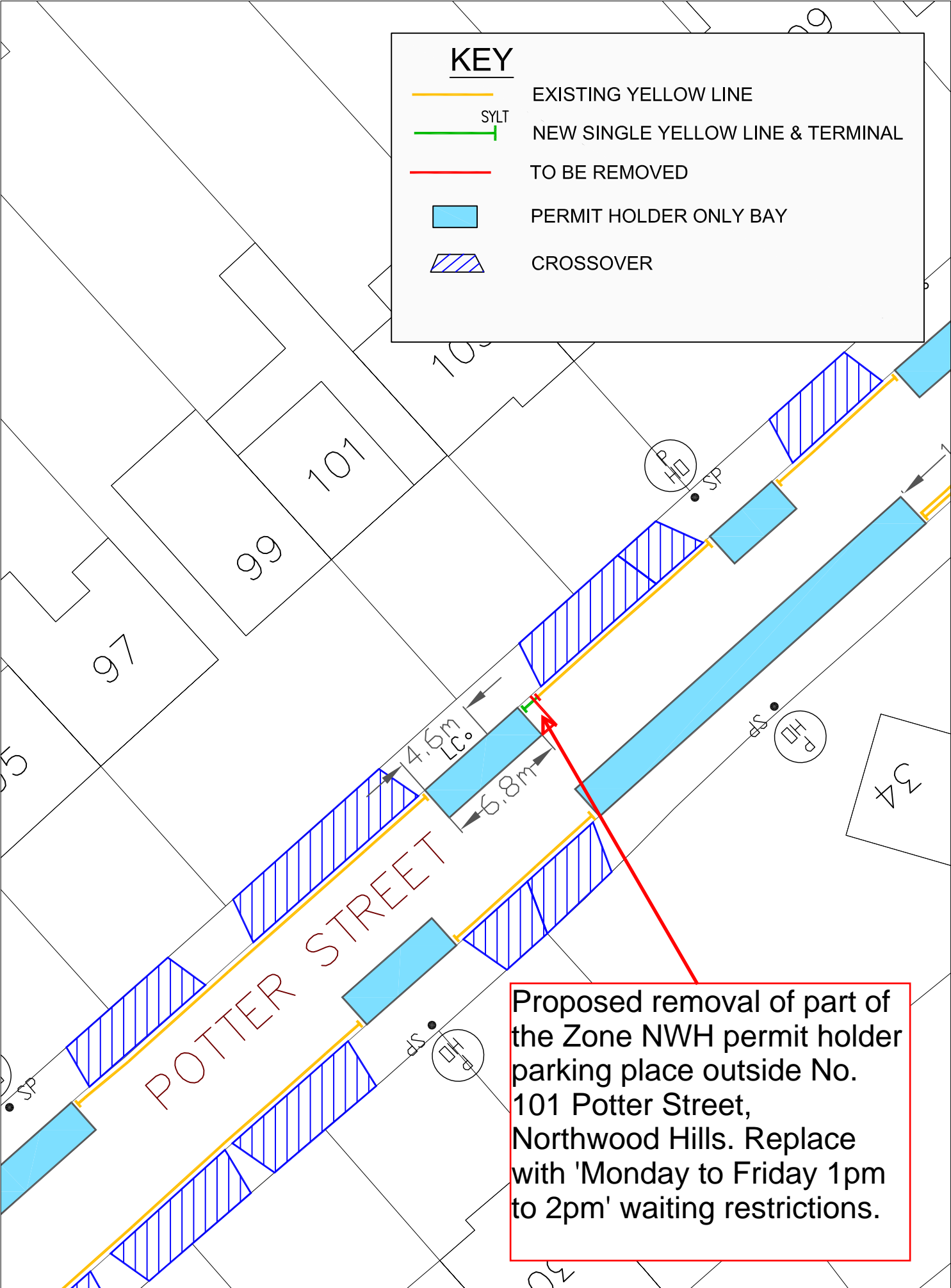



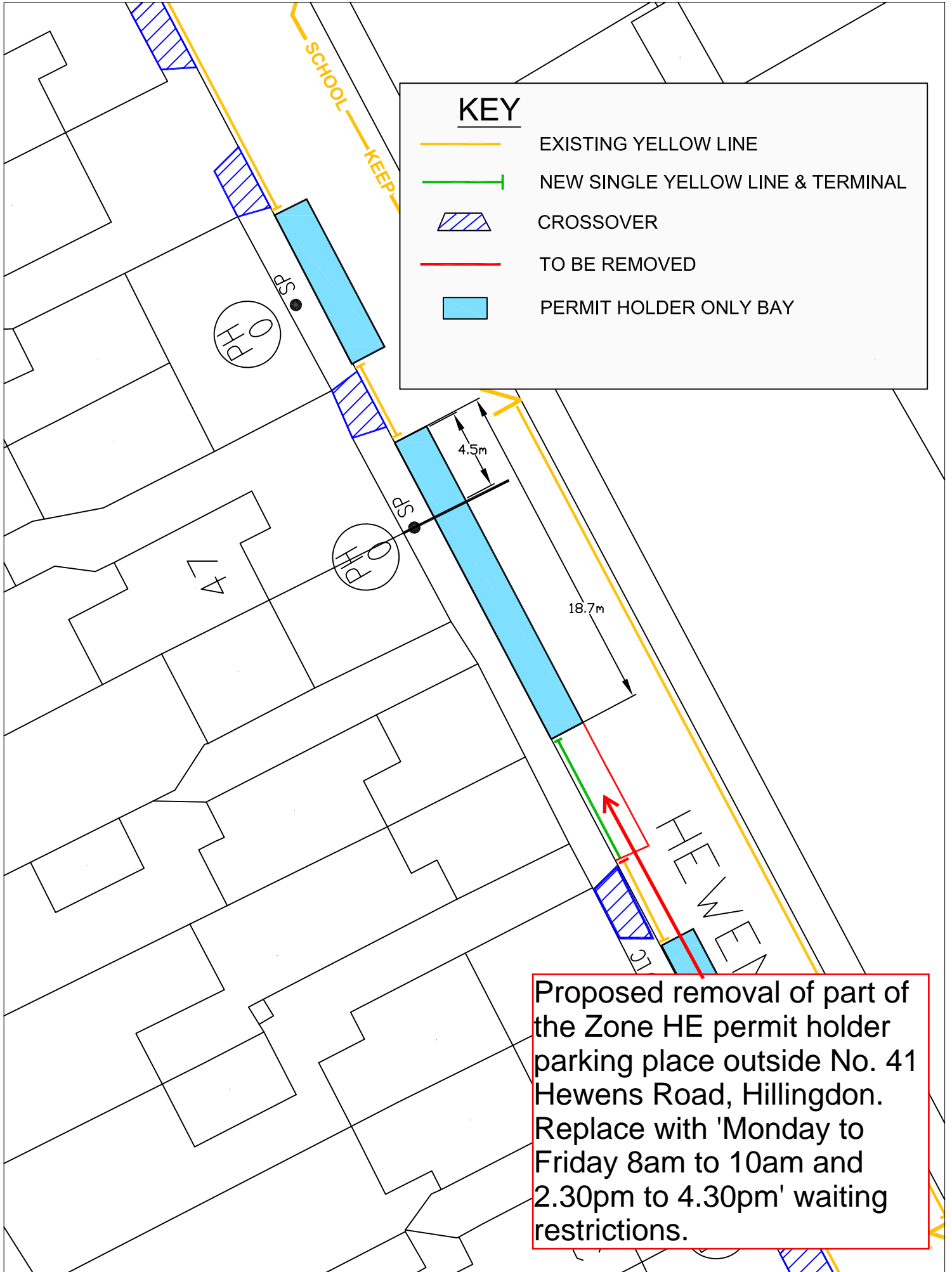

41 Hewens Road, Hayes

Proposed amendments for a new vehicle crossing

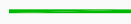

36 Beechwood Avenue, Hillingdon - Proposed amendments for a new vehicle crossing

KEY	
	EXISTING YELLOW LINE
	NEW SINGLE YELLOW LINE & TERMINAL
	CROSSOVER
	TO BE REMOVED
	PERMIT HOLDER ONLY BAY

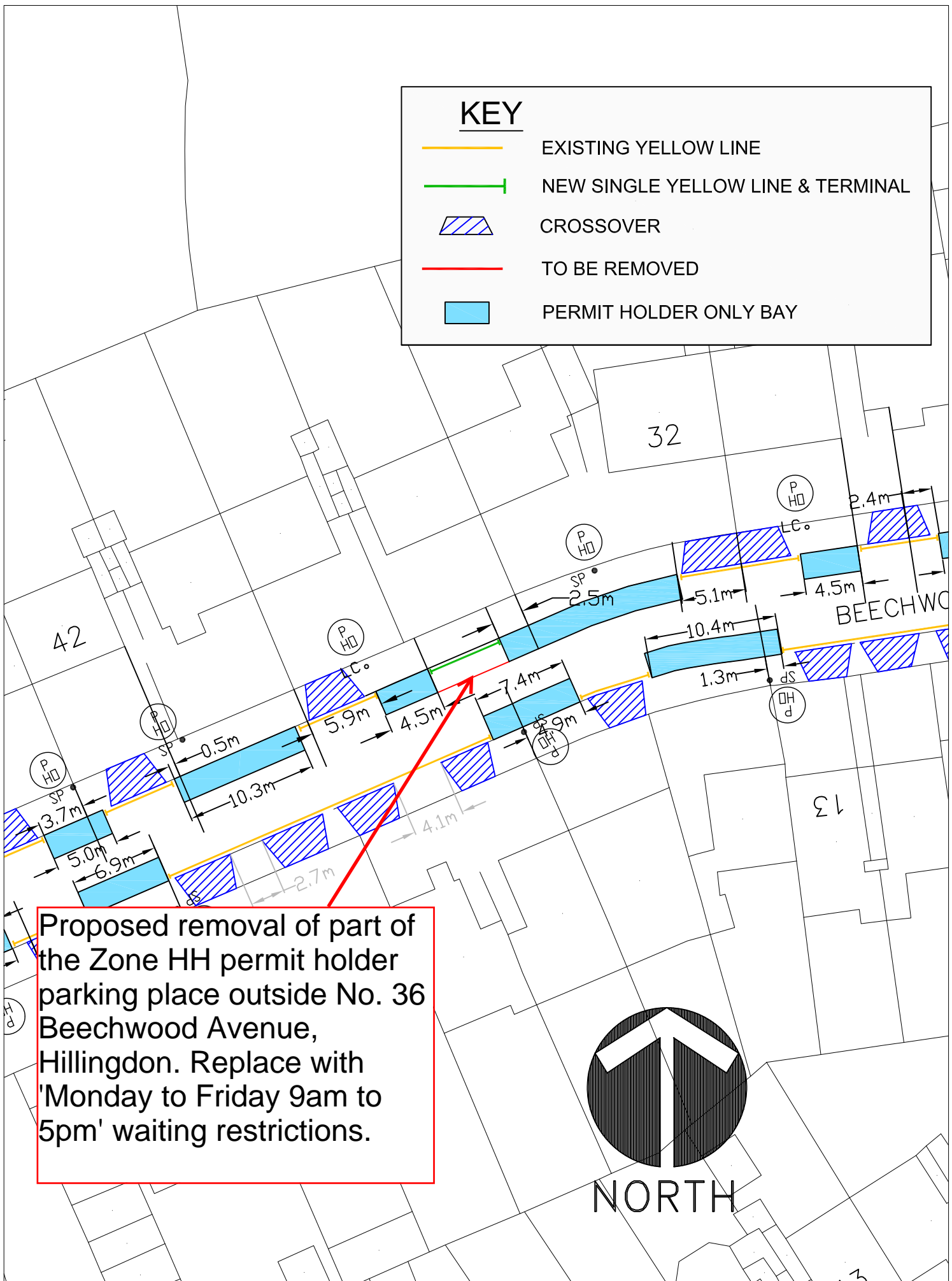

Proposed removal of part of the Zone HH permit holder parking place outside No. 36 Beechwood Avenue, Hillingdon. Replace with 'Monday to Friday 9am to 5pm' waiting restrictions.



19 Cherry Orchard, West Drayton

Proposed amendments for a new vehicle crossing

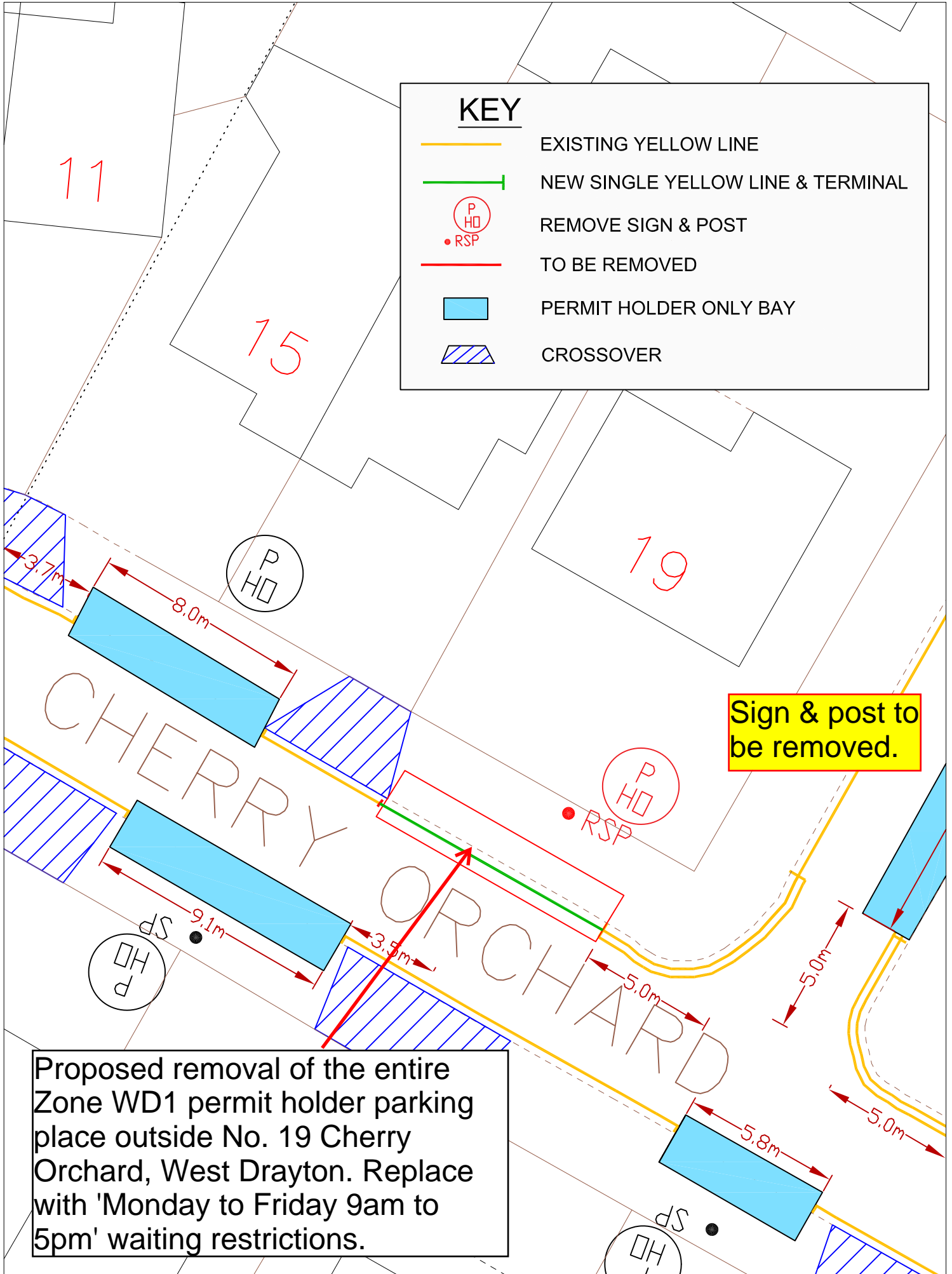

24 Bawtree Road, Uxbridge

Proposed amendments for a new vehicle crossing

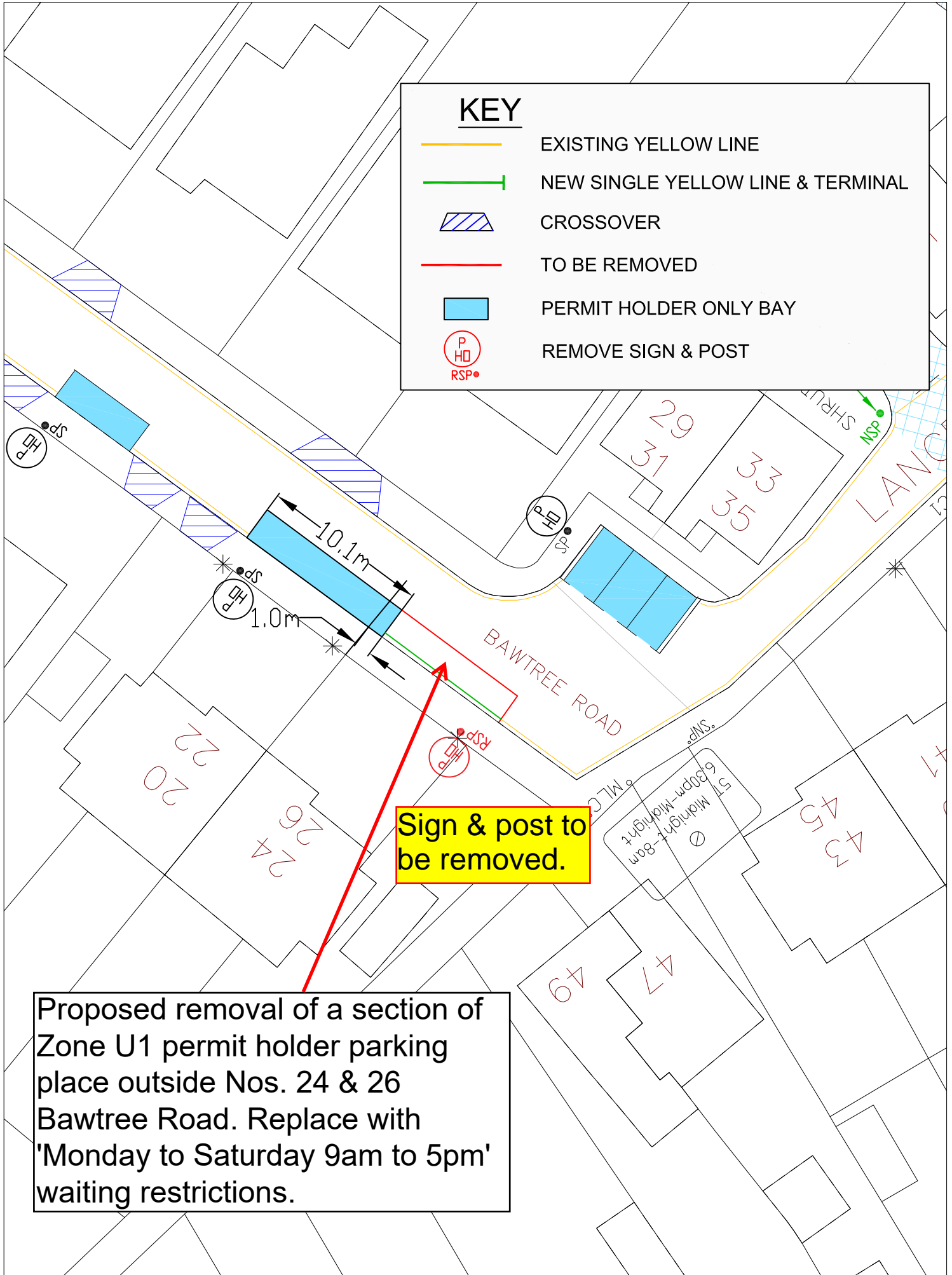



HILLINGDON
LONDON

London Borough of Hillingdon Traffic Management Order

2025 No. **XX**

The Hillingdon (Waiting & Loading Restrictions) Order 2023 (Amendment No. **XX**) Order 2025

Made on **XXXXXXXXXXXX**

Coming into operation **XXXXXXXXXXXX**

The Council of the London Borough of Hillingdon, after consulting the Commissioner of Police of the Metropolis in exercise of the powers conferred by Section 6 and 124 of and part IV of Schedule 9 to the Road Traffic Regulation Act 1984¹ as amended by Section 8 and Schedule 5 of the Local Government Act 1985², the Road Traffic Act 1991³ and of all other enabling powers hereby make the following Order:-

1. This Order shall come into operation on **XXXXXXXXXXXX** and may be cited as The Hillingdon (Waiting & Loading Restrictions) Order 2023 (Amendment No. **XX**) Order 2025.
2. In this Order the expression “enactment” means any enactment, whether public, general or local, and includes any order, bye-law, rule, regulation, scheme or other instrument having effect by virtue of an enactment and any reference in this Order to any enactment shall be construed as a reference to that enactment as amended, applied, consolidated, re-enacted by or as having effect by virtue of any subsequent enactment.
3. Without prejudice to the validity of anything done or to any liability incurred in respect of any act or omission before the coming into operation of this Order, The Hillingdon (Waiting & Loading Restrictions) Order 2023⁴ shall have effect as though:

¹ 1984 c.27

² 1985 c.51

³ 1991 c.40

⁴ 2023 No. 19

- i) the items numbered 1550, 1250, 107, 534, 1238 and 186 in Schedule 1 of that Order were substituted by the items numbered the same as set out in columns 1, 2 and 3 of Schedule 1 of this Order.
- ii) the items numbered NEW were added to Schedule 1 of that Order as set out in columns 1, 2 and 3 of Schedule 1 of this Order.

Dated this the XX day of XXXXXXXXXXXXX

KARRIE WHELAN,
Corporate Director Place

SCHEDULE 1

1	2	3
1550	ABINGDON CLOSE, HILLINGDON	
	1) North to south arm, a) Both sides, from a point in line with the southern kerbline of Court Drive, southwards to a point 0.5 metres north of the northern flank wall of No. 55 Court Drive.	A
	2) Eastern most east to west arm, a) South side, from a point 5.8 metres east of the common boundary of Nos. in line with the northeastern flank wall of No. 9 and 10 Abingdon Close, eastwards to a point in line with the eastern kerbline of the eastern most east to west arm of Abingdon Close.	A
	b) All of the east side of the eastern most east to west arm of Abingdon Close.	A
1250	CHENEY STREET, NORTHWOOD	
	a) Northeast side, from a point in line with the eastern kerbline of Cuckoo Hill southeastwards for a distance of 5 metres.	A
	b) East side, from a point 3.8 metres north of the common boundary of Nos. 6 and 8 Cheney Street, northwards to a point in line with the common boundary of Nos. 12 and 14 Cheney Street.	A
107	LEES ROAD, HILLINGDON	
	a) Both sides, from a point in line with the southwestern kerbline of Uxbridge Road, southwestwards to a point in line with the northeastern boundary of No. 2 Lees Road.	A
	b) The south-east side, i) between a point 10 metres north-east of the north-eastern kerbline of Widmore Road and a point 10 metres south-west of the south-western kerbline of Widmore Road;	A
	ii) between a point 10 metres north-east of the north-eastern kerbline of Aldenham Drive and a point 10 metres south-west of the south-western kerbline of Aldenham Drive.	A
	c) The north-west side, from a point 10 metres southwest of the southwestern kerbline of Bourn Avenue, to a point 10 metres northeast of the northeastern kerbline of Bourn Avenue.	A
534	PERRY CLOSE, HILLINGDON	
	1) East to west arm, a) Both sides, i) between the south-western kerbline of Harlington Road south-westwards for a distance of 10 metres measured on the northern-west side.	A
	ii) between a point in line with the eastern kerbline of the north to south arm of Perry Close, eastwards for a distance of 5 metres.	A
	2) North to south arm, east side, from a point 7 metres north of	A

	the northern kerbline of the east to west arm of Perry Close and a point 5 metres south of the southern kerbline of the east to west arm of Perry Close.	
NEW	SOUTH CLOSE, WEST DRAYTON	
	a) Northeast side, from a point 9.2 metres southeast of the common boundary of Nos. 2 and 4 South Close, southeastwards to a point in line with the northwestern kerbline of South Road.	A
	b) Southwest side, from a point in line with the common boundary of Nos. 1 and 3 South Close, southeastwards to a point in line with the northwestern kerbline of South Road.	A
	c) All sides of the island at the junction with South Road.	
1328	SOUTH ROAD, WEST DRAYTON	
	a) Both sides, from the northeastern kerb line of Thornton Avenue northeastwards for a distance of 10 metres.	A
	b) Northwest side, i) from a point 4.7 metres northeast of the common boundary of Nos. 25 and 27 South Road, northeastwards to a point opposite a point in line with the common boundary of Nos. 12 and 14 South Road.	A
	ii) from a point opposite a point 3.6 metres southwest of the common boundary of Nos. 32 and 34 South Road, southwestwards to a point opposite a point 1.5 metres southwest of the common boundary of Nos. 22 and 24 South Road.	A
186	UXBRIDGE ROAD, UXBRIDGE	
	a) The south west side, i) between the boundary with the London Borough of Ealing and a point opposite the south-eastern wall of No. 192 Uxbridge Road.	C
	ii) between a point 81.89 metres east of the south-eastern kerbline of Coldharbour Lane and a point opposite the party wall of Nos.450/452 and Nos. 454/458 Uxbridge Road, excluding the cycle track.	C
	iii) between a point opposite the party wall of Nos.450/452 and Nos. 454/458 Uxbridge Road and a point 45 metres north-westwards, excluding the cycle track.	A
	iv) between a point 45 metres north-west of a point opposite the party wall of Nos. 450/452 and Nos. 454/458 Uxbridge Road and the south-eastern kerbline of Central Avenue, excluding the cycle track.	C
	v) between the north-western kerbline of Central Avenue and a point opposite a point in line with the common boundary of Nos. 650 and 652 Uxbridge Road.	H
	vi) from a point opposite a point in line with the common boundary of Nos. 650 and 652 Uxbridge Road, to a point in line with the southeastern boundary of Nos. 242 to 252	A

	<p>Addison Way.</p> <p>vii) from a point in line with the southeastern boundary of Nos. 242 to 252 Addison Way, to a point 44 metres south-east of the south-eastern kerbline of Church Road.</p> <p>viii) between a point 44 metres south-east of the south-eastern kerbline of Church Road and a point opposite the common boundary of Nos. 860 and 862 Uxbridge Road, excluding the cycle track.</p> <p>ix) between a point opposite the party wall of Nos. 860 and 862 Uxbridge Road and a point 22 metres east of the eastern kerbline of Gledwood Drive.</p> <p>x) between a point 22 metres east of the eastern kerbline of Gledwood Drive and a point 62 metres west of the western kerbline of Gledwood Drive.</p> <p>xi) between a point 62 metres west of the western kerbline of Gledwood Drive and a point opposite the party wall of Nos. 996/998 and Nos.1000 /1002 Uxbridge Road.</p> <p>xii) between a point opposite the party wall of Nos. 996/998 and Nos.1000 /1002 Uxbridge Road and a point opposite the north-western wall of No. 537 Uxbridge Road.</p> <p>xiii) from a point 3 metres northwest of the common boundary of Nos. 547 and 549 Uxbridge Road for a distance of 45 metres northwest.</p> <p>xiv) between a point opposite the south-eastern wall of No. 621 Uxbridge Road and a point 23 metres south-east of a point opposite the south-eastern wall of No. 731 Uxbridge Road. (except the lay-by outside Nos. 681 to 691 Uxbridge Road)</p> <p>xv) from a point 49.6 metres southeast of the north-western flank wall of Nos. 849 and 851 Uxbridge Road to a point in line with the northwestern kerbline of Morgan's Lane (including all of the service road fronting Nos. 757 to 779 Uxbridge Road, except the section on the northeast side which lies between either entrance of the said service road.)</p> <p>xvi) from a point 2 metres southeast of the north-western flank wall of Nos. 849 and 851 Uxbridge Road, north-westwards for a distance of 70.8 metres.</p> <p>xvii) from a point 70.8 metres northwest of the northwestern flank wall of Nos. 849 and 851 Uxbridge Road, to a point in line with the southeastern kerbline of Fulham Close.</p> <p>xviii) between a point 15 metres south east of the eastern kerbline of New Road and a point 10 metres north west of the western kerbline of New Road.</p> <p>xix) between a point 10 metres north west of the north western kerbline of New Road and a point 10 metres southeast of the southeastern kerbline of Nellgrove Road.</p> <p>xx) from a point in line with the southeastern kerbline of Nellgrove Road, southeastwards for a distance of 10 metres,</p> <p>xxi) from a point in line with the northwestern kerbline of</p>	<p>H</p> <p>C</p> <p>H</p> <p>A</p> <p>H</p> <p>C</p> <p>AA</p> <p>C</p> <p>C</p> <p>A</p> <p>C</p> <p>A</p> <p>A</p> <p>II</p> <p>A</p> <p>II</p>
--	---	--

	<p>Nellgrove Road and a point 10 metres southeast of the southeastern kerbline of Charles Street.</p> <p>xxii) between a point 10 metres southeast of the southeastern kerbline of Charles Street and 3 metres north west of the northwestern kerbline of Charles Street.</p> <p>xxiii) between a point 3 metres northwest of the northwestern kerbline of Charles Street and a point 10 metres southeast of the southeastern kerbline of Westbourne Road.</p> <p>xxiv) between a point 10 metres southeast of the south eastern kerbline of Westbourne Road and a point 10 metres north west of the northwestern kerbline of Westbourne Road.</p> <p>xxv) between a point 10 metres northwest of the western kerbline of Westbourne Road and a point in line with the common boundary of Nos. 6 & 7 Hillingdon Parade, Uxbridge Road.</p> <p>xxvi) from a point in line with the common boundary of Nos. 6 & 7 Hillingdon Parade, Uxbridge Road, northwestwards to a point 7 metres northwest of the northwestern kerbline of Lees Road</p> <p>xxvii) between a point 7 metres northwest of the northwestern kerbline of Lees Road and a point in line with the south-eastern kerbline of Harlington Road, excluding:</p> <ul style="list-style-type: none"> i) The parking bays located between Long Lane and Harlington Road. ii) The south east and south-west sides of the service road fronting Lees Parade. <p>b) The north-east side,</p> <ul style="list-style-type: none"> i) between the boundary with the London Borough of Ealing and a point 3 metres east of a point in line with the north-western wall of No. 65 Delamere Road. ii) between a point 3 metres east of a point in line with the north-western wall of No. 65 Delamere Road and a point 3 metres north-west of a point in line with south-eastern wall of No. 66 Delamere Road. iii) between a point 3 metres north-west of a point in line with south-eastern wall of No. 66 Delamere Road to a point 12 metres southeast of the southeastern kerbline of Brookside Road. Excluding the following sections of road: <ul style="list-style-type: none"> i) The service roads fronting Nos. 2a to 122 Uxbridge Road ii) The lay-by outside No. 124 to 126 Uxbridge Road. iv) between a point 13 metres north-west of the north-western kerbline of Brookside Road and a point 12 metres south-east of the south-eastern kerbline of Brookside Road. v) between a point 13 metres northwest of the northwestern kerbline of Brookside Road, to a point in line with the southeastern flank wall of No. 192 Uxbridge Road. vi) between a point 32.92 metres south-east of the south- 	<p>A</p> <p>C</p> <p>A</p> <p>H</p> <p>A</p> <p>C</p> <p>O</p> <p>A</p> <p>C</p> <p>A</p> <p>C</p> <p>C</p>
--	--	---

	<p>eastern kerbline of Yeading Lane and the south-eastern kerbline of Yeading Lane.</p> <p>vii) from the north-western kerbline of Yeading Lane to a point 45 metres north-west of the party wall of Nos. 450/452 and 454/458 Uxbridge Road. Excluding the following sections of road:</p> <ul style="list-style-type: none"> i) The cycle track. ii) The service road fronting 464/466-474 Uxbridge Road. <p>viii) from a point 45 metres north-west of the party wall of Nos. 450/452 and 454/458 Uxbridge Road to a point in line with the northwestern kerbline of The Warren.</p> <p>ix) from a point 2.95 metres northwest of the common boundary of Nos. 598-600 & 602-604 Uxbridge Road, to a point in line with the northwestern kerbline of The Warren.</p> <p>x) from a point 2.95 metres northwest of the common boundary of Nos. 598-600 & 602-604 Uxbridge Road, to a point a point 2.95 metres northwest of the common boundary of Nos. 666-668 & 670-676 Uxbridge Road..</p> <p>xi) from a point 125.14 metres southeast of the common boundary of Nos. 762-764 & 766-768 Uxbridge Road, to a point a point 2.95 metres northwest of the common boundary of Nos. 666-668 & 670-676 Uxbridge Road.</p> <p>xii) from a point 1.36 metres northwest of the common boundary of Nos. 762-764 & 766-768 Uxbridge Road, southeastwards for a distance of 126.5 metres.</p> <p>xiii) from a point 24 metres southeast of the common boundary of Nos. 784 & 786 and Nos 788-798 Uxbridge Road, to a point 1.36 metres northwest of the common boundary of Nos. 762-764 & 766-768 Uxbridge Road.</p> <p>xiv) from a point in line with the common boundary of Nos. 784 & 786 and Nos 788-798 Uxbridge Road, southeastwards for a distance of 24 metres.</p> <p>xv) from a point in line with the common boundary of Nos. 784 & 786 and Nos 788-798 Uxbridge Road, and a point in line with the common boundary of Nos. 860 and 862 Uxbridge Road, excluding the cycle track.</p> <p>xvi) between a point in line with the common boundary of Nos. 860 and 862 Uxbridge Road and a point 81 metres south-east of the south-eastern kerbline of Gledwood Drive.</p> <p>xvii) from a point 71 metres south-east of the south-eastern kerbline of Gledwood Drive, southeastwards for a distance of 10 metres.</p> <p>xviii) from a point 71 metres south-east of the south-eastern kerbline of Gledwood Drive, northwestwards for a distance of 12 metres.</p> <p>xix) from a point 59 metres south-east of the south-eastern kerbline of Gledwood Drive, northwestwards for a distance of 13.6 metres.</p> <p>xx) from a point 45.4 metres south-east of the south-eastern kerbline of Gledwood Drive, northwestwards for a</p>	<p>A</p> <p>C</p> <p>A</p> <p>C</p> <p>A</p> <p>C</p> <p>A</p> <p>C</p> <p>A</p> <p>C</p> <p>A</p> <p>C</p> <p>A</p> <p>T</p> <p>C</p> <p>T</p> <p>A</p> <p>T</p>
--	--	---

	<p>distance of 36 metres.</p> <p>xxi) between a point 9.4 metres south-east of the south-eastern kerbline of Gledwood Drive and a point 24 metres southeast of the common boundary of Nos. 960 to 970 and Nos. 972 & 974 Uxbridge Road.</p> <p>xxii) from a point in line with the common boundary of Nos. 960 to 970 and Nos. 972 & 974 Uxbridge Road, southeastwards for a distance of 24 metres.</p> <p>xxiii) from a point in line with the common boundary of Nos. 960 to 970 and Nos. 972 & 974 Uxbridge Road, to a point 30 metres southeast of the common boundary of Nos. 1034 and 1040 Uxbridge Road.</p> <p>xxiv) from a point in line with the common boundary of Nos. 1034 and 1040 Uxbridge Road, southeastwards for a distance of 30 metres.</p> <p>xxv) from a point in line with the common boundary of Nos. 1034 and 1040 Uxbridge Road and a point 3.8 metres south-east of the common boundary of Nos.1106 and 1100 Uxbridge Road excluding the cycle track.</p> <p>xxvi) between a point 3.8 metres south-east of the common boundary of Nos.1106 and 1100 Uxbridge Road and a point opposite the north-western wall of No. 537 Uxbridge Road.</p> <p>xxvii) between a point opposite south-eastern flank wall of No. 621 Uxbridge Road and the south-eastern kerbline of Fulham Close excluding the service road fronting Nos. 1250/1252 and 1360/1362 Uxbridge Road.</p> <p>xxviii) between the western kerbline of New Road and the southeastern kerbline of Denziloe Avenue.</p> <p>xxix) between the northwestern kerbline of Denziloe Avenue and a point 0.6 metres northwest of the common boundary of Nos. 29 and 30 New Broadway, Uxbridge Road.</p> <p>xxx) between a point 0.6 metres northwest of the common boundary of Nos. 29 and 30 New Broadway, Uxbridge Road and the western kerbline of Long Lane.</p> <p>xxxi) between a point in line with the western kerbline of Long Lane and a point in line with the common boundary of Nos. 1 and 2 Crescent Parade, excluding the service road fronting Crescent Parade.</p> <p>xxxii) from a point in line with the common boundary of Nos. 1 and 2 Crescent Parade and a point in line with the south-eastern kerbline of Harlington Road, excluding the service road fronting Crescent Parade.</p> <p>xxxiii) between the eastern kerbline of Vine Lane and a point 15.24 metres east of that kerbline.</p> <p>c) The service road fronting Nos. 590 –766 Uxbridge Road,</p> <p>1. the north-east side</p> <p>2. the south-west side,</p> <p>i) from a point in line with the southeastern kerbline of Warley Road, to a point in line with the common boundary of Nos. 762-764 & 766-768 Uxbridge Road.</p>	<p>A</p> <p>C</p> <p>A</p> <p>C</p> <p>A</p> <p>C</p> <p>C</p> <p>C</p> <p>A</p> <p>C</p> <p>C</p> <p>A</p> <p>A</p> <p>A</p> <p>A</p> <p>A</p>
--	---	---

<p>ii) between a point in line with the common boundary of Nos. 762-764 & 766-768 Uxbridge Road, to a point in line with the common boundary of Nos, 686 & 688-690 Uxbridge Road.</p>	C
<p>iii) from a point in line with the common boundary of Nos, 686 & 688-690 Uxbridge Road, to a point 1.63 metres northwest of the common boundary of Nos. 666-668 & 670-676 Uxbridge Road.</p>	A
<p>iv) from a point 1.63 metres northwest of the common boundary of Nos. 666-668 & 670-676 Uxbridge Road to a point in line with the common boundary of Nos. 598-600 & 602-604 Uxbridge Road.</p>	C
<p>v) from a point in line with the common boundary of Nos. 598-600 & 602-604 Uxbridge Road, to a point in line with the northwestern kerbline of Shakespeare Avenue.</p>	A
<p>d) the service road fronting Nos. 1250/1252 and 1360/1362 Uxbridge Road.</p>	
<p>1) The entire northeast side of the service road,</p>	A
<p>2) The entire northwest side of the service road,</p>	A
<p>3) The southwest side,</p>	
<p>i) from a point in line with the northeastern kerbline of the main carriageway of the Uxbridge Road, southeastwards for a distance of 5 metres.</p>	A
<p>ii) from a point opposite a point 24 metres northwest of the northwestern kerbline of Hayes End Drive, northwestwards for a distance of 12.6 metres.</p>	A
<p>iii) from a point opposite a point 15.5 metres northwest of the northwestern kerbline of Hayes End Drive, to a point opposite a point 5.1 metres southeast of the southeastern kerbline of Hayes End Drive.</p>	A
<p>iv) from a point opposite a point in line with the common boundary of Nos. 1300 and 1302 Uxbridge Road, northwestwards for a distance of 10 metres.</p>	A
<p>v) from a point opposite a point 1.9 metres southeast of the common boundary of Nos. 1266 and 1270 Uxbridge Road. Northwestwards for a distance of 11 metres.</p>	A
<p>vi) from a point in line with the northwestern kerbline of Newport Road, northwestwards for a distance of 9.1 metres.</p>	A
<p>e) Service road fronting No. 1390 Uxbridge Road to No. 1 Addiscombe Court, both sides, from a point 10 metres southeast of the southeastern kerbline of Paget Road to a point 10 metres northwest of the northwestern kerbline of Paget Road.</p>	A
<p>f) Service road fronting Byron Parade, Blenheim Parade and Marlborough Parade.</p>	
<p>i) the southwest side.</p>	C
<p>ii) the northeast side, from a point 2.6 metres southeast of the common boundary of Nos. 6 & 7 Marlborough Parade to a point 5.2 metres northwest of the common boundary of Nos. 10 and 11 Marlborough Parade.</p>	A

	<p>iii) northeast side, from a point 10 metres southeast of the southeastern kerb line of Butler Street northwestwards to a point 12.7 metres northwest of the northwestern kerb line of Butler Street.</p> <p>g) Service road which lies on the northeast side, fronting Nos. 1-24 New Broadway.</p> <p>i) northeast side, from the northern kerblines of Uxbridge Road northwestwards to a point 6 metres southeast of the common boundary of Nos. 1 and 2 New Broadway.</p> <p>ii) northeast side, from a point 6 metres southeast of the common boundary of Nos. 1 and 2 New Broadway, to a point 0.6 metres northwest of the northwestern flank wall of No. 10 New Broadway.</p> <p>iii) northeast side, from a point 0.6 metres northwest of the northwestern flank wall of No. 10 New Broadway to a point 8.2 metres northwest of the northwestern kerblines of Parkfield Avenue.</p> <p>iv) northeast side, from a point 8.2 metres northwest of the northwestern kerblines of Parkfield Avenue, to a point in line with the common boundary Nos. 18 and 19 New Broadway.</p> <p>v) northeast side, from a point in line with the southeastern kerblines of Denziloe Avenue, southeastwards for a distance of 10 metres.</p> <p>vi) the southwest side</p> <p>h) Service Road fronting Nos. 1-17 Crescent Parade:-</p> <p>1. The south west, south and south east sides, from its junction with Uxbridge Road to its junction with Long Lane.</p> <p>2. The north west side, from its junction with Uxbridge Road to a point 5 metres north east of the northeastern kerblines of Uxbridge Road.</p> <p>3. The west side, from a point 2.5 metres south of the northern flank wall of No. 17 Crescent Parade extending on to the south side of the access road to the rear of Crescent Parade to a point 13 metres west of the western kerblines of the service road.</p> <p>4. The north side, between a point 3.5 metres south of the common boundary of Nos. 10 and 11 Crescent Parade and a point .35 metres west of the common boundary of Nos. 9 and 10 Crescent Parade.</p>	<p>A</p> <p>A</p> <p>C</p> <p>A</p> <p>C</p> <p>A</p> <p>A</p> <p>A</p> <p>A</p> <p>A</p> <p>A</p> <p>A</p>
--	--	---

KEY

A = 'At any time' waiting restrictions.

AA = 'Monday to Friday 8am to 6.30pm' waiting restrictions.

C = 'Monday to Saturday 8am to 6.30pm' waiting restrictions.

H = 'Monday to Friday 8am to 9.30am and between 4.30pm to 6.30pm' waiting restrictions.

II = 'Monday to Friday 8am to 9am and between 5pm to 7pm' waiting restrictions.

O = '7am to 7pm' waiting restrictions.

T = 'Monday to Saturday 8am to 9.30am' waiting restrictions.



HILLINGDON
LONDON

London Borough of Hillingdon Traffic Management Order

2024 No. ??

The Hillingdon (Free Parking Places) (Disabled Persons) (Amendment No. XX) Traffic Order 2024

Made on ??????????

Coming into operation on ??????????

The London Borough of Hillingdon, after consulting the Commissioner of Police of Metropolis, in exercise of the powers conferred by section 6 of the Road Traffic Regulation Act 1984¹, as amended The Local Government Act 1985² and of all other powers thereunto enabling hereby make the following Order:

1. This Order shall come into operation on the ?????????? and may be cited as The Hillingdon (Free Parking Places) (Disabled Persons) (Amendment No. ??) Traffic Order 2024.
2. Without prejudice to the validity of anything done or to any liability incurred in respect of any act or omission before the coming into operation of this Order, The Hillingdon (Free Parking Places) (Disabled Persons) Traffic Order 2024³ shall have effect as though:
 - i) there were parking places added to Schedule 1 of that Order as set out in Schedule 1 of this Order.
 - ii) the parking places numbered 825, 203, 558 and 933 in Schedule 1 of that Order were deleted.

Dated this the ?? day of ??????????????

KARRIE WHELAN,
Corporate Director Place

¹ 1984 c.27
² 1985 c.51
³ 2024 No. 42

SCHEDULE 1

Location	Number of bays	Permit Number
<p>DUNEDIN WAY, YEADING – Northeast side, from a point 1.5 metres southeast of the northwestern kerbline of the arm of Dunedin Way fronting Napier Court and Lyttleton Court, southeastwards for a distance of 2.5 metres, with a bay length of 5 metres.</p> <p>SPECIAL MANNER OF STANDING: Vehicles to park at 90 degrees to the northeastern kerbline, with either the front or rear wheels closest to the northeastern edge of the carriageway.</p>	1	TBC
<p>BROMLEY CRESCENT, RUISLIP – Southeast side, from a point in line with the northeastern flank wall of Nos. 32 and 34 Bromley Crescent, southwestwards for a distance of 5 metres.</p>	1	TBC



HILLINGDON
LONDON

London Borough of Hillingdon Traffic Management Order

2025 No. XX

The Hillingdon (On Street Parking Places) (Yiewsley Parking Management Scheme) Y Zones Order 2024 (Amendment No. XX) Order 2025

Made on XX

Coming into operation XX

The Council of the London Borough of Hillingdon (hereinafter referred to as “the Council”) in exercise of its powers under Sections 45, 46, 51 and 124 of and Part III and Part IV of Schedule 9 to the Road Traffic Regulation Act 1984¹ as amended by The Local Government Act 1985², The Road Traffic Regulation (Parking) Act 1986³, the Parking Act 1989⁴ and The Road Traffic Act 1991⁵ and all other powers enabling it in that behalf and after consultation with the Chief Officer of Police hereby makes the following Order.

1. This Order shall come into operation on the XX and may be cited as The Hillingdon (On Street Parking Places) (Yiewsley Parking Management Scheme) Y Zones Order 2024 (Amendment No. XX) Order 2025.
2. Without prejudice to the validity of anything done or to any liability incurred in respect of any act or omission before the coming into operation of this Order as The Hillingdon (On Street Parking Places) (Yiewsley Parking Management Scheme) Y Zones Order 2024⁶ shall have effect as though Schedule 2 of that Order was substituted by Schedule 2 of this Order.

¹ 1984 c.27

² 1985 c.51

³ 1986 c.27

⁴ 1989 c.16

⁵ 1991 c.40

⁶ 2024 No. 9

Dated this the xx day of xxx

KARRIE WHELAN,
Corporate Director Place

SCHEDULE 2

RESIDENT PERMIT HOLDERS PARKING PLACES - ZONE Y1

In relation to the parking place referred to in this schedule, the expression "permitted hours," means the period between 'Monday to Saturday 9am to 6pm' inclusive, any such day not being Christmas Day, Good Friday or a Bank Holiday. Parking places in which a vehicle may be left during the permitted hours if it displays a valid Zone Y1 permit or visitor voucher or has been granted either a virtual residents permit or virtual visitor voucher. All parking places are 2 metres wide unless otherwise stated.

Parking Place No.	Designated Parking Place
1	ALBERT ROAD, The east side, from a point opposite a point in line with the southern flank wall of Nos. 1 and 3 Albert Road to a point 0.2 metres north of the northern flank wall of No. 46 Albert Road.
2	ALBERT ROAD, The east side, from a point 0.5 metres north of the southern flank wall of Nos. 56 and 58 Albert Road, northwards for a distance of 4.8 metres.
3	ALBERT ROAD, The east side, from a point 6.2 metres south of the southern flank wall of No. 60 Albert Road northwards for a distance of 11.3 metres.
4	ALBERT ROAD, The east side, from a point in line with the common boundary of Nos. 62 and 64 Albert Road southwards for a distance of 4.5 metres.
5	ALBERT ROAD, The west side, from a point in line with the northern flank wall of No. 61 Albert Road, to a point 21.3 metres south of the common boundary of Nos. 47 and 47a Albert Road.
6	ALBERT ROAD, The west side, from a point 1.8 metres south of the common boundary of Nos. 35 and 37 Albert Road southwards for a distance of 17.5 metres.
7	ALBERT ROAD, The west side, from a point 0.7 metres south of the northern flank of No. 29 Albert Road southwards for a distance of 50.7 metres.
8	ALBERT ROAD, The west side, from a point 8.0 metres north of the northern kerbline of the western access of road of Albert Road northwards for a distance of 11.4 metres.

SCHEDULE 2

RESIDENT PERMIT HOLDERS PARKING PLACES - ZONE Y1

In relation to the parking place referred to in this schedule, the expression "permitted hours," means the period between 'Monday to Saturday 9am to 6pm' inclusive, any such day not being Christmas Day, Good Friday or a Bank Holiday. Parking places in which a vehicle may be left during the permitted hours if it displays a valid Zone Y1 permit or visitor voucher or has been granted either a virtual residents permit or virtual visitor voucher. All parking places are 2 metres wide unless otherwise stated.

Parking Place No.	Designated Parking Place
9	BENTINCK ROAD, The southwest side, from a point 6.0 metres southeast of the southeastern kerbline of Padcroft Road to a point 6.0 metres northwest of the northwestern kerbline of Wimpole Road.
10	BENTINCK ROAD, The southwest side, from a point 4.0 metres southeast of the southeastern kerbline of Wimpole Road to a point 6.0 metres northwest of the northwestern kerbline of Winnock Road.
11	HEATHCOTE WAY, The southwest side, from a point 6.1 metres north west of the northwestern kerbline of Padcroft Road, northwestward for a distance of 10.0 metres.
12	HEATHCOTE WAY, The southwest side, from a point 36.5 metres north west of the northwestern kerbline of Padcroft Road, northwestward for a distance of 8.9 metres.
13	HEATHCOTE WAY, The southwest side, from a point 54.8 metres north west of the northwestern kerbline of Padcroft Road, northwestward for a distance of 10.0 metres.
14	HEATHCOTE WAY, The north side, from a point 14.5 metres east of the northeastern kerbline of Padcroft Road, eastward for a distance of 14.5 metres.
15	HORTON ROAD, The southeast side, from a point in line with the southwestern flank wall of No 10 Horton Road northeastwards for a distance of 34.0 metres.

SCHEDULE 2

RESIDENT PERMIT HOLDERS PARKING PLACES - ZONE Y1

In relation to the parking place referred to in this schedule, the expression "permitted hours," means the period between 'Monday to Saturday 9am to 6pm' inclusive, any such day not being Christmas Day, Good Friday or a Bank Holiday. Parking places in which a vehicle may be left during the permitted hours if it displays a valid Zone Y1 permit or visitor voucher or has been granted either a virtual residents permit or virtual visitor voucher. All parking places are 2 metres wide unless otherwise stated.

Parking Place No.	Designated Parking Place
16	HORTON ROAD, The southside, from a point 1.4 metres east of the western flank wall of No 14 Horton Road eastwards for a distance of 22.0 metres.
17	HORTON ROAD, The northside, the layby fronting Nos. 99 – 129 Horton Road.
18	PEPLOW CLOSE, The northeast and northwest sides, from a point 9.1 metres northeast of the northeastern kerbline of Heathcote Way, northeastwards for a distance of 25 metres.
19	PEPLOW CLOSE, The northeast and northwest sides, from a point 42.5 metres northeast of the northeastern kerbline of Heathcote Way, eastwards for a distance of 17.7 metres.
20	PEPLOW CLOSE, The northeast and northwest side, from the southeastern most kerbline of Peplow Close, northwestwards for a distance of 6.0 metres.
21	PADCROFT ROAD, The northwest side, from a point 10.0 metres northeast of the northeastern kerbline of Tavistock Road northeastwards for a distance of 10.9 metres.
22	PADCROFT ROAD, The northwest side, from a point 7.0 metres southwest of the southwestern kerbline of Heathcote Way southwestwards for a distance of 10.0 metres.

SCHEDULE 2

RESIDENT PERMIT HOLDERS PARKING PLACES - ZONE Y1

In relation to the parking place referred to in this schedule, the expression "permitted hours," means the period between 'Monday to Saturday 9am to 6pm' inclusive, any such day not being Christmas Day, Good Friday or a Bank Holiday. Parking places in which a vehicle may be left during the permitted hours if it displays a valid Zone Y1 permit or visitor voucher or has been granted either a virtual residents permit or virtual visitor voucher. All parking places are 2 metres wide unless otherwise stated.

Parking Place No.	Designated Parking Place
23	PADCROFT ROAD, The northwest side, from a point 17.4 metres northeast of the northeastern kerbline of Heathcote Way northeastwards for a distance of 14.3 metres. SPECIAL MANNER OF STANDING: Vehicles permitted to park on the footway with two wheels only for a distance of 1.2 metres from the kerb.
24	PADCROFT ROAD, The northwest side, from a point 0.3 metres northeast of a point opposite a point in line with the common boundary of Nos. 12 and 13 Padcroft Road northeastwards for a distance of 8.3 metres SPECIAL MANNER OF STANDING: Vehicles permitted to park on the footway with two wheels only for a distance of 1.2 metres from the kerb.
25	PADCROFT ROAD, The northwest side, from a point 2.7 metres northeast of a point opposite a point in line with the common boundary of Nos. 15 and 16/17 Padcroft Road northeastwards for a distance of 13.8 metres. SPECIAL MANNER OF STANDING: Vehicles permitted to park on the footway with two wheels only for a distance of 1.2 metres from the kerb.
26	PADCROFT ROAD, The southeast side, from a point 6.0 metres southwest of the southwestern kerbline of Bentinck Road southwestwards for a distance of 14.6 metres

SCHEDULE 2

RESIDENT PERMIT HOLDERS PARKING PLACES - ZONE Y1

In relation to the parking place referred to in this schedule, the expression "permitted hours," means the period between 'Monday to Saturday 9am to 6pm' inclusive, any such day not being Christmas Day, Good Friday or a Bank Holiday. Parking places in which a vehicle may be left during the permitted hours if it displays a valid Zone Y1 permit or visitor voucher or has been granted either a virtual residents permit or virtual visitor voucher. All parking places are 2 metres wide unless otherwise stated.

Parking Place No.	Designated Parking Place
27	PADCROFT ROAD, The southeast side, from a point 3.6 metres southwest of the northeastern flank wall of Nos. 16 and 17 Padcroft Road, southwestwards to a point in line with the southwest flank wall of No.7 Padcroft Road. SPECIAL MANNER OF STANDING: Vehicles permitted to park on the footway with two wheels only for a distance of 1.6 metres from the kerb.
28	PADCROFT ROAD, The southeast side, from a point in line with the northeast flank wall of No.6 Padcroft Road to a point 17.0 metres northeast of the northeastern kerblines of Tavistock Road.
29	ST STEPHENS ROAD, The northeast to southwest arm, the southeast side, from a point 6.0 metres northeast of a point opposite a point in line with the northeastern most extremity of No. 2 St Stephens Road northeastwards for a distance of 26.5 metres.
30	ST STEPHENS ROAD, The northeast to southwest arm, the southeast side, from a point 4.5 metres northeast of the northeastern flank wall of No. 15a St Stephens Road northeastwards for a distance of 38.0 metres.
31	ST STEPHENS ROAD, The northeast to southwest arm, the southeast side, from a point 17.0 metres northeast of the northeastern kerblines of the northwest to southeast arm of St Stephens Road northeastwards for a distance of 7.0 metres.
32	ST STEPHENS ROAD, The northeast to southwest arm, the northwest side, from a point 1.0 metre northeast of the southwestern flank wall of No. 4 St Stephens Road northeastwards for a distance of 9.0 metres.

SCHEDULE 2

RESIDENT PERMIT HOLDERS PARKING PLACES - ZONE Y1

In relation to the parking place referred to in this schedule, the expression "permitted hours," means the period between 'Monday to Saturday 9am to 6pm' inclusive, any such day not being Christmas Day, Good Friday or a Bank Holiday. Parking places in which a vehicle may be left during the permitted hours if it displays a valid Zone Y1 permit or visitor voucher or has been granted either a virtual residents permit or virtual visitor voucher. All parking places are 2 metres wide unless otherwise stated.

Parking Place No.	Designated Parking Place
33	ST STEPHENS ROAD, The northeast to southwest arm, the northwest side, from a point in line with the common boundary of Nos. 12 and 14 St Stephens Road southwestwards for a distance of 4.5 metres.
34	ST STEPHENS ROAD, The northeast to southwest arm, the northwest side, from a point 0.8 metres northeast of the common boundary of Nos. 18 and 20 St Stephens Road southwestwards for a distance of 4.5 metres.
35	TAVISTOCK ROAD, The northeast side, from a point 10.0 metres southeast of the southeast of the southeastern kerbline of Padcroft Road to a point 8.0 metres northwest of the northwestern kerbline of Wimpole Road.
36	TAVISTOCK ROAD, The northeast side, from a point 8.0 metres southeast of the southeastern kerbline of Wimpole Road southeastwards for a distance of 20.0 metres.
37	TAVISTOCK ROAD, The northeast side, from a point 10.0 metres northwest of the northwestern kerbline of Winnock Road northwestwards for a distance 24.5 metres.
38	TAVISTOCK ROAD, The southwest side, from a point opposite a point in line with the northwestern kerbline of Padcroft Road to a point 3.5 metres northwest of a point opposite a point in line with the common boundary of Nos. 34 and 35 Tavistock Road.
39	TAVISTOCK ROAD, The southwest side, from a point in line with the common boundary of Nos. 30 and 31 Tavistock Road southeastwards for a distance of 18.0 metres.

SCHEDULE 2

RESIDENT PERMIT HOLDERS PARKING PLACES - ZONE Y1

In relation to the parking place referred to in this schedule, the expression "permitted hours," means the period between 'Monday to Saturday 9am to 6pm' inclusive, any such day not being Christmas Day, Good Friday or a Bank Holiday. Parking places in which a vehicle may be left during the permitted hours if it displays a valid Zone Y1 permit or visitor voucher or has been granted either a virtual residents permit or virtual visitor voucher. All parking places are 2 metres wide unless otherwise stated.

Parking Place No.	Designated Parking Place
40	TAVISTOCK ROAD, The southwest side, from a point opposite a point in line with the northwestern kerbline of Wimpole Road southeastwards for a distance of 8.2 metres.
41	TAVISTOCK ROAD, The southwest side, from a point 1.5 metres southeast of a point opposite a point in line with the common boundary of Nos. 24 and 25 Tavistock Road, to a point opposite a point 10 metres northwest of the northwestern kerbline of Winnock Road.
42	TROUT ROAD, The northwest side, from a point 1.3 metres southwest of the northeastern boundary of Premier Nursery southwestwards for distance of 11.3 metres.
43	TROUT ROAD, The northwest side, from a point in line with the northeastern flank wall of Churchill House, Trout Road southwestwards for a distance of 5.6 metres.
44	TROUT ROAD, The northwest side, from a point 1.4 metres southwest of the southwestern most boundary of Churchill House, Trout Road southwestwards for a distance of 22.0 metres.
45	TROUT ROAD, The northwest side, from a point 30.3 metres southwest of the southwestern most boundary of Churchill House, Trout Road southwestwards for a distance of 14.0 metres.
46	WIMPOLE ROAD, The northwest side, from a point 8.0 metres northeast of the northeastern kerbline of Tavistock Road northeastwards for a distance of 11.1 metres.

SCHEDULE 2

RESIDENT PERMIT HOLDERS PARKING PLACES - ZONE Y1

In relation to the parking place referred to in this schedule, the expression "permitted hours," means the period between 'Monday to Saturday 9am to 6pm' inclusive, any such day not being Christmas Day, Good Friday or a Bank Holiday. Parking places in which a vehicle may be left during the permitted hours if it displays a valid Zone Y1 permit or visitor voucher or has been granted either a virtual residents permit or virtual visitor voucher. All parking places are 2 metres wide unless otherwise stated.

Parking Place No.	Designated Parking Place
47	WIMPOLE ROAD, The northwest side, from a point in line with the south western most boundary of No.1a Wimpole Road southwestwards for a distance of 10.4 metres.
48	WIMPOLE ROAD, The northwest side, from a point 1.8 metres northeast of the common boundary of Nos. 1a and 1 Wimpole Road northeastwards for a distance of 24.0 metres.
49	WIMPOLE ROAD, The northwest side, from a point in line with the common boundary of Nos. 11 and 13 Wimpole Road to a point 0.5 metres northeast of the northeastern most flank wall of No. 29 Wimpole Road.
50	WIMPOLE ROAD, The northwest side, from a point 6.0 metres southwest of the southwestern kerblines of Bentinck Road southwestwards for a distance of 22.7 metres.
51	WIMPOLE ROAD, The southeast side, from a point 4.7 metres northeast of the northeastern flank wall of The Ivy Leaf Club, Wimpole Road southwestwards for a distance of 19.5 metres.
52	WIMPOLE ROAD, The southeast side, from a point 1.4 metres southwest of the northeastern flank wall of Nos. 32 and 34 Wimpole Road to a point 4.2 metres southwest of the common boundary of Nos. 2 and 4 Wimpole Road.
53	WIMPOLE ROAD, The southeast side, from a point 8.0 metres northeast of the northeastern kerblines of Tavistock northeastwards for a distance of 17.0 metres.

SCHEDULE 2

RESIDENT PERMIT HOLDERS PARKING PLACES - ZONE Y1

In relation to the parking place referred to in this schedule, the expression "permitted hours," means the period between 'Monday to Saturday 9am to 6pm' inclusive, any such day not being Christmas Day, Good Friday or a Bank Holiday. Parking places in which a vehicle may be left during the permitted hours if it displays a valid Zone Y1 permit or visitor voucher or has been granted either a virtual residents permit or virtual visitor voucher. All parking places are 2 metres wide unless otherwise stated.

Parking Place No.	Designated Parking Place
54	WINNOCK ROAD, The northwest side, from a point 1.7 metres southwest of the northeastern flank wall of No. 41 Bentinck Road, to a point 4.4 metres northeast of the southwestern flank wall of No.41 Bentinck Road.
55	WINNOCK ROAD, The northwest side, from a point 4.5 metres northeast of the common boundary of Nos. 31 and 33 Winnock Road, southwestwards to a point 2.1 metres northeast of the common boundary of Nos. 23 and 25 Winnock Road.
56	WINNOCK ROAD, The northwest side, from a point 3.4 metres southwest of the common boundary of Nos. 23 and 25 Winnock Road, southwestwards for a distance of 5.0 metres.
57	WINNOCK ROAD, The northwest side, from a point 4.5 metres northeast of the common boundary of Nos. 17 and 19 Winnock Road, southwestwards for a distance of 9.4 metres.
58	WINNOCK ROAD, The northwest side, from a point 2.7 metres northeast of the common boundary of Nos.13 and 15 Winnock Road, southwestwards for a distance of 5.9 metres.
59	WINNOCK ROAD, The northwest side, from a point 4 metres northeast of the common boundary, to a point 2.0 metres southwest of the southwestern flank wall of No. 1 Winnock Road.
60	WINNOCK ROAD, The northwest side, from a point 9.1 metres northeast of the southwestern flank wall of No. 15 Tavistock Road, northeastwards for a distance of 11.0 metres.

SCHEDULE 2

RESIDENT PERMIT HOLDERS PARKING PLACES - ZONE Y1

In relation to the parking place referred to in this schedule, the expression "permitted hours," means the period between 'Monday to Saturday 9am to 6pm' inclusive, any such day not being Christmas Day, Good Friday or a Bank Holiday. Parking places in which a vehicle may be left during the permitted hours if it displays a valid Zone Y1 permit or visitor voucher or has been granted either a virtual residents permit or virtual visitor voucher. All parking places are 2 metres wide unless otherwise stated.

Parking Place No.	Designated Parking Place
61	WINNOCK ROAD, The southeast side, from a point 10 metres northeast of the northeastern kerblines of Tavistock Road, to a point 0.9 metres southwest of the common boundary of Nos. 46 and 48 Winnock Road.



HILLINGDON
LONDON

London Borough of Hillingdon Traffic Management Order

2025 No. XX

The Hillingdon (On Street Parking Places) (Hillingdon Hill Parking Management Scheme) Zone HN1 Order 2023 (Amendment No. XX) Order 2025

Made on xx

Coming into operation on xx

The Council of the London Borough of Hillingdon (hereinafter referred to as “the Council”) in exercise of its powers under Sections 45, 46, 51 and 124 of and Part III and Part IV of Schedule 9 to the Road Traffic Regulation Act 1984¹ as amended by The Local Government Act 1985², The Road Traffic Regulation (Parking) Act 1986³, the Parking Act 1989⁴ and The Road Traffic Act 1991⁵ and all other powers enabling it in that behalf and after consultation with the Chief Officer of Police hereby makes the following Order.

1. This Order shall come into operation on the xxx and may be cited as The Hillingdon (On Street Parking Places) (Hillingdon Hill Parking Management Scheme) Zone HN1 Order 2023 (Amendment No. xx) Order 2025.
2. Without prejudice to the validity of anything done or to any liability incurred in respect of any act or omission before the coming into operation of this Order as The Hillingdon (On Street Parking Places) (Hillingdon Hill Parking Management Scheme) Zone HN1 Order 2023⁶ shall have effect as though the parking place numbered 50 in Schedule 1 of that Order was deleted.

¹ 1984 c.27

² 1985 c.51

³ 1986 c.27

⁴ 1989 c.16

⁵ 1991 c.40

⁶ 2023 No. 27

Dated this the xx day of xxx

KARRIE WHELAN,
Corporate Director Place



HILLINGDON
LONDON

London Borough of Hillingdon Traffic Management Order

2025 No. xx

The Hillingdon (On Street Parking Places) (Northwood Hills Parking Management Scheme) NWH & JS(B) Zones Order 2022 (Amendment No. x) Order 2025

Made on xx

Coming into operation on xx

The Council of the London Borough of Hillingdon (hereinafter referred to as “the Council”) in exercise of its powers under Sections 45, 46, 51 and 124 of and Part III and Part IV of Schedule 9 to the Road Traffic Regulation Act 1984¹ as amended by The Local Government Act 1985², The Road Traffic Regulation (Parking) Act 1986³, the Parking Act 1989⁴ and The Road Traffic Act 1991⁵ and all other powers enabling it in that behalf and after consultation with the Chief Officer of Police hereby makes the following Order.

1. This Order shall come into operation on the xx and may be cited as The Hillingdon (On Street Parking Places) (Northwood Hills Parking Management Scheme) NWH & JS(B) Zones Order 2022 (Amendment No. xx) Order 2025.
2. Without prejudice to the validity of anything done or to any liability incurred in respect of any act or omission before the coming into operation of this Order as The Hillingdon (On Street Parking Places) (Northwood Hills Parking Management Scheme) NWH & JS(B) Zones Order 2022⁶ shall have effect as though the parking place numbered 207 in Schedule 1 of that Order were substituted by the parking place numbered the same as set out in Schedule 1 of this Order.

¹ 1984 c.27

² 1985 c.51

³ 1986 c.27

⁴ 1989 c.16

⁵ 1991 c.40

⁶ 2022 No. 53

Dated this the xx day of xx

KARRIE WHELAN,
Corporate Director Place

SCHEDULE 1

RESIDENT PERMIT HOLDERS PARKING PLACES - ZONE NWH

In relation to the parking place referred to in this schedule, the expression "permitted hours," means the period between 'Monday to Friday 1pm to 2pm' inclusive, any such day not being Christmas Day, Good Friday or a Bank Holiday. Parking places in which a vehicle may be left during the permitted hours if it displays a valid Zone NWH permit or visitor voucher or has been granted either a virtual permit or virtual visitor voucher. All parking places are 2 metres wide unless otherwise stated.

Parking Place No.	Designated Parking Place
207	POTTER STREET, The southwest to northeast arm, the northwest side, from a point 4.6 metres southwest of the common boundary of Nos. 99 and 101 Potter Street, northeastwards for a distance of 6.8 metres.



HILLINGDON
LONDON

London Borough of Hillingdon Traffic Management Order

2025 No. XX

The Hillingdon (On Street Parking Places) (Hayes End & Hillingdon Heath Parking Management Schemes) HE & VC Zones Order 2023 (Amendment No. xx) Order 2025

Made on XX

Coming into operation XX

The Council of the London Borough of Hillingdon (hereinafter referred to as “the Council”) in exercise of its powers under Sections 45, 46, 51 and 124 of and Part III and Part IV of Schedule 9 to the Road Traffic Regulation Act 1984¹ as amended by The Local Government Act 1985², The Road Traffic Regulation (Parking) Act 1986³, the Parking Act 1989⁴ and The Road Traffic Act 1991⁵ and all other powers enabling it in that behalf and after consultation with the Chief Officer of Police hereby makes the following Order.

1. This Order shall come into operation on the xx and may be cited as The Hillingdon (On Street Parking Places) (Hayes End & Hillingdon Heath Parking Management Schemes) HE & VC Zones Order 2023 (Amendment No. xx) Order 2025
2. Without prejudice to the validity of anything done or to any liability incurred in respect of any act or omission before the coming into operation of this Order as The Hillingdon (On Street Parking Places) (Hayes End & Hillingdon Heath Parking Management Schemes) HE & VC Zones Order 2023⁶ shall have effect as though Schedule 1 of that Order was substituted by Schedule 1 of this Order.

¹ 1984 c.27

² 1985 c.51

³ 1986 c.27

⁴ 1989 c.16

⁵ 1991 c.40

⁶ 2023 No. 58

Dated this the xx day of xx

KARRIE WHELAN,
Corporate Director Place

SCHEDULE 1

RESIDENT PERMIT HOLDERS PARKING PLACES - ZONE HE

In relation to the parking place referred to in this schedule, the expression "permitted hours," means the period between 'Monday to Friday 8am to 10am and 2.30pm to 4.30pm', any such day not being Christmas Day, Good Friday or a Bank Holiday. Parking places in which a vehicle may be left during the permitted hours if it displays a valid Zone HE permit, visitor voucher or has been granted either a virtual residents permit or virtual visitor voucher. All parking places are 2 metres wide unless otherwise stated.

Parking Place No.	Designated Parking Place
1	HEWENS ROAD, UXBRIDGE - West Side, from a point 17.7 metres northwest of the southeastern property line of No.1372 Uxbridge Road, northwestwards to a point 23.7 metres northwest of the southeastern property line of No.1372 Uxbridge Road.
2	HEWENS ROAD, UXBRIDGE - West Side, from a point 19.0 metres southeast of a point in line with the common boundary of No.1380 Uxbridge Road and the park, to a point 14.5 metres southeast of a point in line with the common boundary of No.1380 Uxbridge Road and the park.
3	HEWENS ROAD, UXBRIDGE - West Side, from a point 4.8 metres southeast of a point in line with the common boundary of No.1380 Uxbridge Road and the park, to a point 11.3 metres northwest of a point in line with the common boundary of No.1380 Uxbridge Road and the park.
4	HEWENS ROAD, UXBRIDGE - West Side, from a point 7.2 metres northwest of the southeastern property boundary of No.1 Hewens Road, northwestwards for a distance of 5.8 metres.
5	HEWENS ROAD, UXBRIDGE - West Side, from a point 19 metres northwest of the southeastern property boundary of No.1 Hewens Road, northwestwards for a distance of 9.9 metres.
6	HEWENS ROAD, UXBRIDGE - West Side, from a point 7.1 metres northwest of the shared property boundary of Nos.7 and 9 Hewens Road, to a point 5.9 metres southeast of the shared property boundary of Nos.15 and 17 Hewens Road.

SCHEDULE 1

RESIDENT PERMIT HOLDERS PARKING PLACES - ZONE HE

In relation to the parking place referred to in this schedule, the expression "permitted hours," means the period between 'Monday to Friday 8am to 10am and 2.30pm to 4.30pm', any such day not being Christmas Day, Good Friday or a Bank Holiday. Parking places in which a vehicle may be left during the permitted hours if it displays a valid Zone HE permit, visitor voucher or has been granted either a virtual residents permit or virtual visitor voucher. All parking places are 2 metres wide unless otherwise stated.

Parking Place No.	Designated Parking Place
7	HEWENS ROAD, UXBRIDGE - West Side, from a point 5.5 metres northwest of the shared property boundary of Nos.15 and 17 Hewens Road, to a point 4.2 metres southeast of the shared property boundary of Nos.19 and 21 Hewens Road.
8	HEWENS ROAD, UXBRIDGE - West Side, from a point in line with the common boundary of Nos. 23 and 25 Hewens Road, northwestwards for a distance of 5.5 metres.
9	HEWENS ROAD, UXBRIDGE - West Side, from a point 0.9 metres northwest of the common boundary of Nos. 27 and 29 Hewens Road, northwestwards for a distance of 11 metres.
10	HEWENS ROAD, UXBRIDGE - West Side, from a point 4.2 metres northwest of the southeastern building line of No.33 Hewens Road, to a point 2.0 metres southeast of the northeastern building line of No.35 Hewens Road.
11	HEWENS ROAD, UXBRIDGE - West Side, from a point 4.5 metres northwest of the common boundary of Nos. 45 and 47 Hewens Road, southeastwards for a distance of 18.7 metres.
12	HEWENS ROAD, UXBRIDGE - West Side, from a point 0.8 metres northwest of the southeastern building line of No.49, to point 3.7 metres southeast of the southeastern building line of No.53.
13	HEWENS ROAD, UXBRIDGE - West Side, from a point 5.6 metres southeast of the party wall of Nos.61a and 61b, to a point 1.1 metres southeast of the party wall of Nos.61a and 61b.

SCHEDULE 1

RESIDENT PERMIT HOLDERS PARKING PLACES - ZONE HE

In relation to the parking place referred to in this schedule, the expression "permitted hours," means the period between 'Monday to Friday 8am to 10am and 2.30pm to 4.30pm', any such day not being Christmas Day, Good Friday or a Bank Holiday. Parking places in which a vehicle may be left during the permitted hours if it displays a valid Zone HE permit, visitor voucher or has been granted either a virtual residents permit or virtual visitor voucher. All parking places are 2 metres wide unless otherwise stated.

Parking Place No.	Designated Parking Place
14	HEWENS ROAD, UXBRIDGE - West Side, from a point 3.0 metres southeast of the party wall of Nos.63A and 63B Hewens Road, to a point 2.8 metres northeast of the party wall of 63A and 63B Hewens Road.
15	HEWENS ROAD, UXBRIDGE - West Side, from a point 8.8 metres northwest of the party wall of 63A and 63B Hewens Road, to a point 13.3 metres northwest of the party wall of 63A and 63B Hewens Road.
16	HEWENS ROAD, UXBRIDGE - West Side, from a point 20.0 metres northwest of the party wall of 63A and 63B Hewens Road, to a point 3.0 metres northwest of the northwestern building line of Sandringham Court, Hewens Road.
17	HEWENS ROAD, UXBRIDGE - West Side, from a point 24.5 metres south of a point in line with the common boundary of Nos.17 and 19 Hewens Road, to a point 13.9 metres south of a point in line with the common boundary of Nos.17 and 18 Hewens Road.
18	HEWENS ROAD, UXBRIDGE - West Side, from a point 5.4 metres south of a point in line with the common boundary of Nos.17 and 19 Hewens Road, to a point 3.2 metres north of a point in line with the common boundary of Nos.17 and 19 Hewens Road.
19	HEWENS ROAD, UXBRIDGE - West Side, from a point 9.9 metres north of a point in line with the common boundary of Nos.17 and 19 Hewens Road, to a point 18.9 metres north of a point in line with the common boundary of Nos.17 and 19 Hewens Road.

SCHEDULE 1

RESIDENT PERMIT HOLDERS PARKING PLACES - ZONE HE

In relation to the parking place referred to in this schedule, the expression "permitted hours," means the period between 'Monday to Friday 8am to 10am and 2.30pm to 4.30pm', any such day not being Christmas Day, Good Friday or a Bank Holiday. Parking places in which a vehicle may be left during the permitted hours if it displays a valid Zone HE permit, visitor voucher or has been granted either a virtual residents permit or virtual visitor voucher. All parking places are 2 metres wide unless otherwise stated.

Parking Place No.	Designated Parking Place
20	HEWENS ROAD, UXBRIDGE - West Side, from a point 24.0 metres north of a point in line with the common boundary of Nos.17 and 19 Hewens Road, to a point 37.8 metres north of a point in line with the common boundary of Nos.17 and 19 Hewens Road.
21	HEWENS ROAD, UXBRIDGE - West Side, from a point 47.2 metres north of a point in line with the common boundary of Nos.17 and 19 Hewens Road, to a point 52.2 metres north of a point in line with the common boundary of Nos.17 and 19 Hewens Road.
22	HEWENS ROAD, UXBRIDGE - East Side, from a point 5.5 metres southeast of a point in line with the northwestern boundary of No.20 Hewens Road, to a point 3.2 metres southeast of a point in line with the common boundary of Nos.18 and 20 Hewens Road.
23	HEWENS ROAD, UXBRIDGE - East Side, from a point 10.9 metres southeast of a point in line with the common boundary of Nos.18 and 20 Hewens Road, to a point 4.6 metres southeast of a point in line with the common boundary of Nos.14 and 16 Hewens Road.
24	HEWENS ROAD, UXBRIDGE - East Side, from a point 11.2 metres southeast of a point in line with the common boundary of Nos.14 and 16 Hewens Road, to a point 11.4 metres northwest of a point in line with the common boundary of Nos.6 and 8 Hewens Road.
25	HEWENS ROAD, UXBRIDGE - East Side, from a point 4.7 metres northwest of a point in line with the common boundary of Nos.6 and 8 Hewens Road , to a point 4.9 metres southeast of a point in line with the common boundary of Nos.6 and 8 Hewens Road.

SCHEDULE 1

RESIDENT PERMIT HOLDERS PARKING PLACES - ZONE HE

In relation to the parking place referred to in this schedule, the expression "permitted hours," means the period between 'Monday to Friday 8am to 10am and 2.30pm to 4.30pm', any such day not being Christmas Day, Good Friday or a Bank Holiday. Parking places in which a vehicle may be left during the permitted hours if it displays a valid Zone HE permit, visitor voucher or has been granted either a virtual residents permit or virtual visitor voucher. All parking places are 2 metres wide unless otherwise stated.

Parking Place No.	Designated Parking Place
26	HEWENS ROAD, UXBRIDGE - East Side, from a point 11.6 metres southeast of a point in line with the common boundary of Nos.6 and 8 Hewens Road, southeastwards for a distance of 5.0 metres.
27	HEWENS ROAD, UXBRIDGE - West Side, from a point 17.7 metres northwest of the southeastern property line of No.1372 Uxbridge Road, northwestwards to a point 23.7 metres northwest of the southeastern property line of No.1372 Uxbridge Road.



HILLINGDON
LONDON

London Borough of Hillingdon Traffic Management Order

2025 No. XX

The Hillingdon (On Street Parking Places) (Hillingdon Hospital Parking Management Scheme) HH Zones Order 2022 (Amendment No. X) Order 2025

Made on XX

Coming into operation XX

The Council of the London Borough of Hillingdon (hereinafter referred to as “the Council”) in exercise of its powers under Sections 45, 46, 51 and 124 of and Part III and Part IV of Schedule 9 to the Road Traffic Regulation Act 1984¹ as amended by The Local Government Act 1985², The Road Traffic Regulation (Parking) Act 1986³, the Parking Act 1989⁴ and The Road Traffic Act 1991⁵ and all other powers enabling it in that behalf and after consultation with the Chief Officer of Police hereby makes the following Order.

1. This Order shall come into operation on the XXX and may be cited as The Hillingdon (On Street Parking Places) (Hillingdon Hospital Parking Management Scheme) HH Zones Order 2022 (Amendment No. X) Order 2025.
2. Without prejudice to the validity of anything done or to any liability incurred in respect of any act or omission before the coming into operation of this Order as The Hillingdon (On Street Parking Places) (Hillingdon Hospital Parking Management Scheme) HH Zones Order 2022⁶ shall have effect as though the parking placed numbered 35 in Schedule 1 of that Order was substituted by the parking places numbered 35a and 35b as set out in Schedule 1 of this Order.

¹ 1984 c.27

² 1985 c.51

³ 1986 c.27

⁴ 1989 c.16

⁵ 1991 c.40

⁶ 2022 No. 27

Dated this the XX day of XXX

KARRIE WHELAN,
Corporate Director Place

SCHEDULE 1

RESIDENT PERMIT HOLDERS PARKING PLACES - ZONE HH

In relation to the parking place referred to in this schedule, the expression "permitted hours," means the period between 'Monday to Friday 9am to 5pm' inclusive, any such day not being Christmas Day, Good Friday or a Bank Holiday. Parking places in which a vehicle may be left during the permitted hours if it displays a valid Zone HH permit or visitor voucher or has been granted either a virtual permit or virtual visitor voucher. All parking places are 2 metres wide unless otherwise stated.

Parking Place No.	Designated Parking Place
35a	BEECHWOOD AVENUE, the northwest side, from a point 5.1 metres southwest of the common boundary of Nos. 30 and 32 Beechwood Avenue, to a point 2.5 metres southwest of the common boundary of Nos. 34 and 36 Beechwood Avenue.
35b	BEECHWOOD AVENUE, the northwest side, from a point 5.9 metres northeast of the common boundary of Nos. 37 and 40 Beechwood Avenue, northeastwards for a distance of 4.5 metres.



HILLINGDON
LONDON

London Borough of Hillingdon Traffic Management Order

2025 No. **XX**

The Hillingdon (On Street Parking Places) (West Drayton Parking Management Scheme) WD Zones (Amendment No. **XX**) Order 2025

Made on **XXX**

Coming into operation on **XXX**

The Council of the London Borough of Hillingdon (hereinafter referred to as “the Council”) in exercise of its powers under Sections 45, 46, 51 and 124 of and Part III and Part IV of Schedule 9 to the Road Traffic Regulation Act 1984¹ as amended by The Local Government Act 1985², The Road Traffic Regulation (Parking) Act 1986³, the Parking Act 1989⁴ and The Road Traffic Act 1991⁵ and all other powers enabling it in that behalf and after consultation with the Chief Officer of Police hereby makes the following Order.

1. This Order shall come into operation on the **XXX 2025** and may be cited as The Hillingdon (On Street Parking Places) (West Drayton Parking Management Scheme) WD Zones (Amendment No. **XX**) Order 2025.
2. Without prejudice to the validity of anything done or to any liability incurred in respect of any act or omission before the coming into operation of this Order as The Hillingdon (On Street Parking Places) (West Drayton Parking Management Scheme) WD Zones Order 2024⁶ shall have effect as though the parking place numbered 22 in Schedule 1 of that order was deleted.

¹ 1984 c.27

² 1985 c.51

³ 1986 c.27

⁴ 1989 c.16

⁵ 1991 c.40

⁶ 2024 No. 31

Dated this the XX day of XXX

KARRIE WHELAN,
Corporate Director Place



HILLINGDON
LONDON

London Borough of Hillingdon Traffic Management Order

2025 No. XX

The Hillingdon (On Street Parking Places) (Uxbridge North Parking Management Scheme) Zones U1, U3, U7, U8, U9 & U10 Order 2023 (Amendment No. XX) Order 2025

Made on XX

Coming into operation XX

The Council of the London Borough of Hillingdon (hereinafter referred to as “the Council”) in exercise of its powers under Sections 45, 46, 51 and 124 of and Part III and Part IV of Schedule 9 to the Road Traffic Regulation Act 1984¹ as amended by The Local Government Act 1985², The Road Traffic Regulation (Parking) Act 1986³, the Parking Act 1989⁴ and The Road Traffic Act 1991⁵ and all other powers enabling it in that behalf and after consultation with the Chief Officer of Police hereby makes the following Order.

1. This Order shall come into operation on the XX 2025 and may be cited as The Hillingdon (On Street Parking Places) (Uxbridge North Parking Management Scheme) Zones U1, U3, U7, U8, U9 & U10 Order 2023 (Amendment No. XX) Order 2025.
2. Without prejudice to the validity of anything done or to any liability incurred in respect of any act or omission before the coming into operation of this Order as The Hillingdon (On Street Parking Places) (Uxbridge North Parking Management Scheme) Zones U1, U3, U7, U8, U9 & U10 Order 2023⁶ shall have effect as though the parking place numbered 3 in Schedule 1 of that

¹ 1984 c.27

² 1985 c.51

³ 1986 c.27

⁴ 1989 c.16

⁵ 1991 c.40

⁶ 2023 No. 5

Order was substituted by the parking place numbered the same as set out within Schedule 1 of this Order.

Dated this the XX day of XXX 2025

KARRIE WHELAN,
Corporate Director Place

SCHEDULE 1

RESIDENT PERMIT HOLDERS PARKING PLACES - ZONE U1

In relation to the parking place referred to in this schedule, the expression "permitted hours," means the period between 'Monday to Saturday 9am to 5pm' inclusive, any such day not being Christmas Day, Good Friday or a Bank Holiday. Parking places in which a vehicle may be left during the permitted hours if it displays a valid Zone U1 permit or visitor voucher or has been granted either a virtual residents permit or virtual visitor voucher. All parking places are 2 metres wide unless otherwise stated.

Parking Place No.	Designated Parking Place
3	BAWTREE ROAD, The southwest side, from a point 2.8 metres northwest of a point in line with the common boundary of Nos. 2a and 4 Bawtree Road to a point 5.8 metres northwest of the southeastern boundary of Nos. 24 and 26 Bawtree Road.